

NIGHTBLOOM PENDANT LAMP 40/60

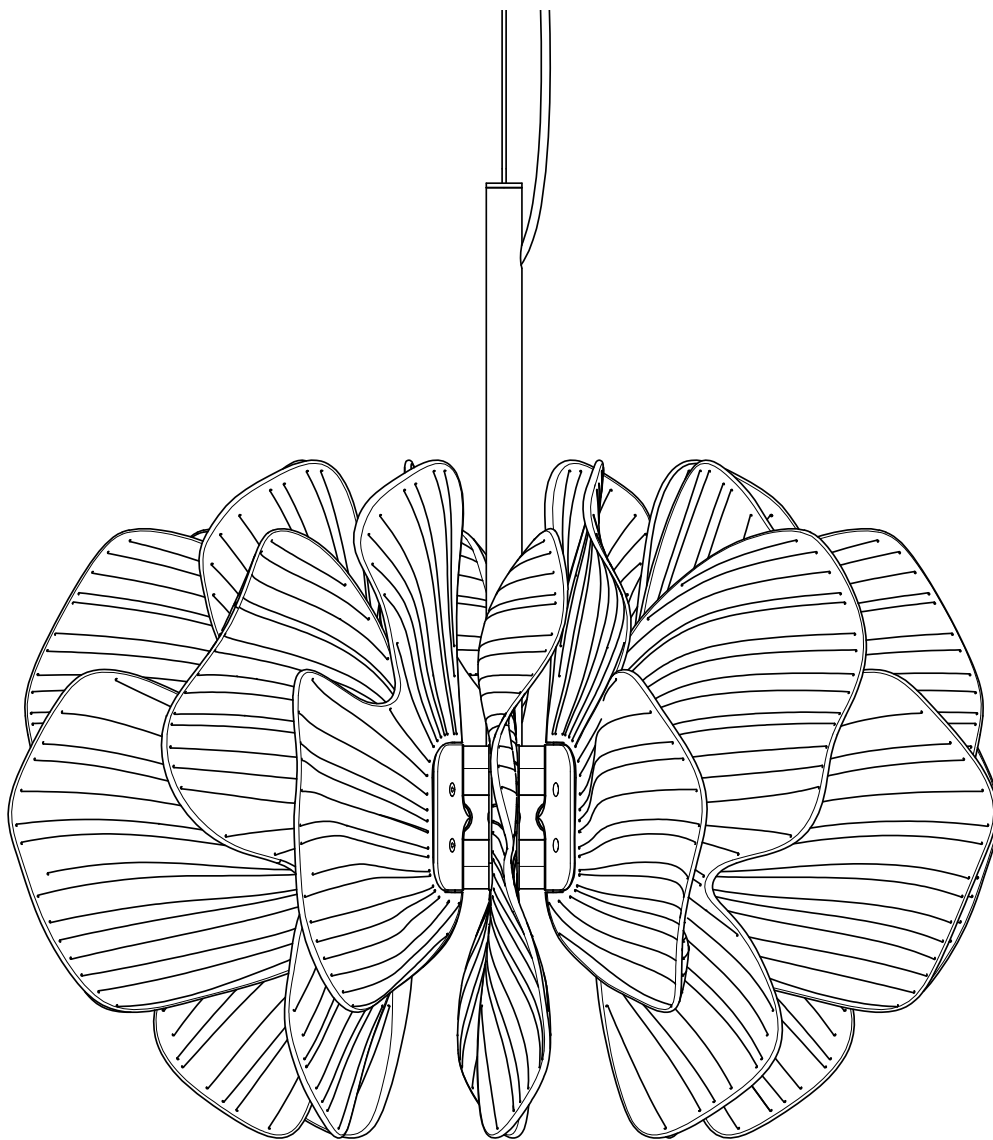

LLADRÓ
HANDMADE PORCELAIN
Spain

INSTALLATION GUIDE / *GUIDE D'INSTALLATION*

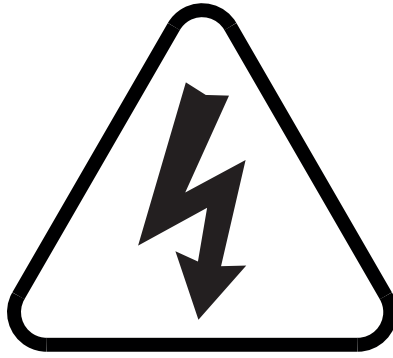

REF. 01023986 - NIGHTBLOOM 40 (CE/UK)
REF. 01023987 - NIGHTBLOOM 40 (US)
REF. 01023988 - NIGHTBLOOM 40 (JP)

REF. 01023983 - NIGHTBLOOM 60 (CE/UK)
REF. 01023984 - NIGHTBLOOM 60 (US)
REF. 01023985 - NIGHTBLOOM 60 (JP)



AVISO DE SEGURIDAD

LA INSTALACIÓN DE ESTA LUMINARIA SUPONE TRABAJAR CON UN NIVEL DE VOLTAJE PELIGROSO. SI USTED NO ESTÁ AL TANTO DE LAS MEDIDAS DE SEGURIDAD QUE SE DEBEN TOMAR, POR FAVOR PIDA A UN PROFESIONAL CUALIFICADO QUE REALICE LA INSTALACIÓN.

SI EL CABLE FLEXIBLE O CORDÓN EXTERIOR DE ESTA LUMINARIA ESTÁ DAÑADO, DEBE SUSTITUIRSE EXCLUSIVAMENTE POR EL FABRICANTE O SU SERVICIO TÉCNICO (O UNA PERSONA DE CUALIFICACIÓN EQUIVALENTE), CON EL OBJETO DE EVITAR CUALQUIER RIESGO.

LUMINARIA SOLO APTA PARA USO INTERIOR.

SAFETY ADVICE

THE INSTALLATION OF THIS LIGHTING PRODUCT IMPLIES WORKING WITH HIGH VOLTAGE CURRENT. IF YOU ARE NOT AWARE OF THE SAFETY MEASURES INVOLVED, PLEASE ASK A CERTIFIED ELECTRICIAN TO DO THE WORK.

IF THE EXTERNAL CORD IS DAMAGED, IT MUST BE REPLACED ONLY BY A QUALIFIED PERSON ASWELL.

THIS LUMINAIRE IS FOR INDOOR USE ONLY.

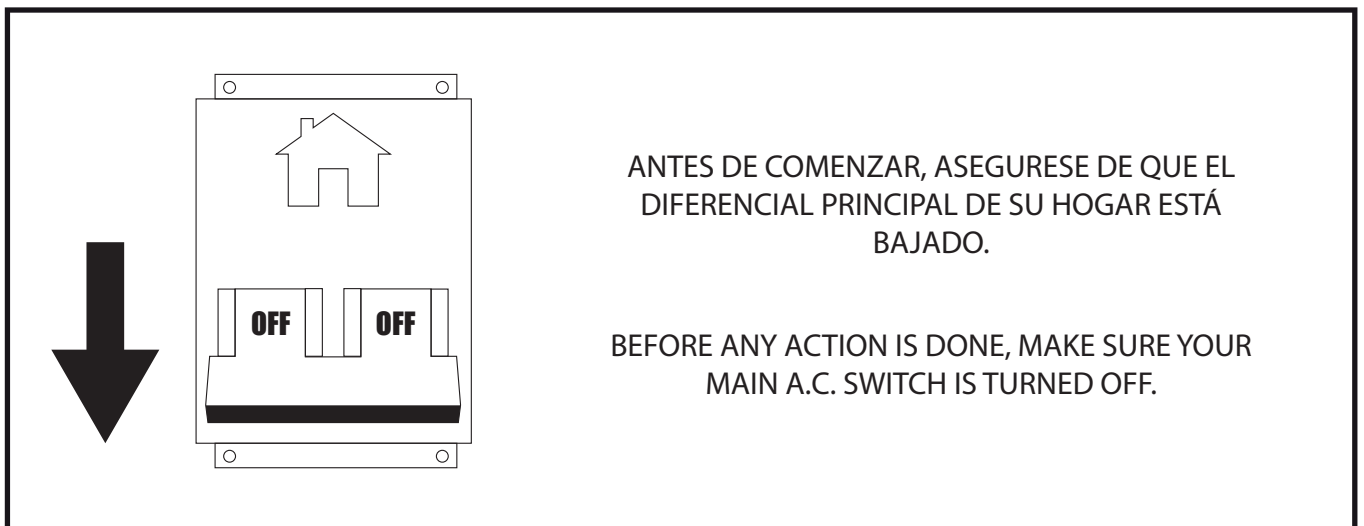

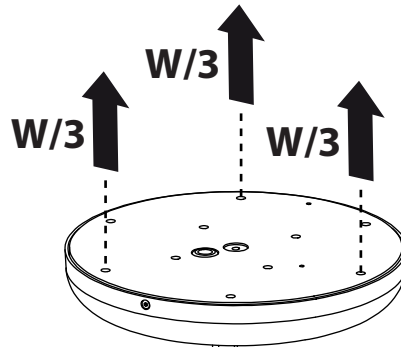

**CHECK YOUR
CEILING MAXIMUM LOAD**
VÉRIFIER LA CHARGE MAXIMALE
DE VOTRE PLAFOND



Version	Weight (W)	W/3	x4 Sec. factor
Pendant 40	7.6 Kg	2.5 Kg	10 Kg
Pendant 60	22 Kg	7.3 Kg	29.3 Kg

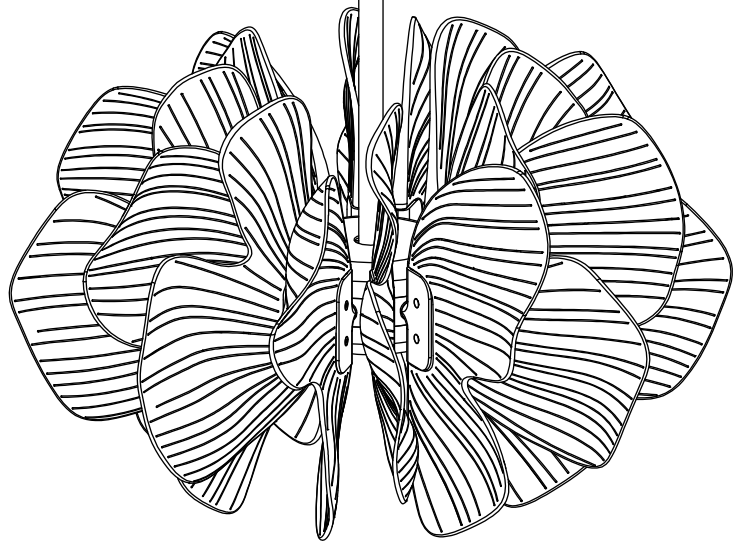

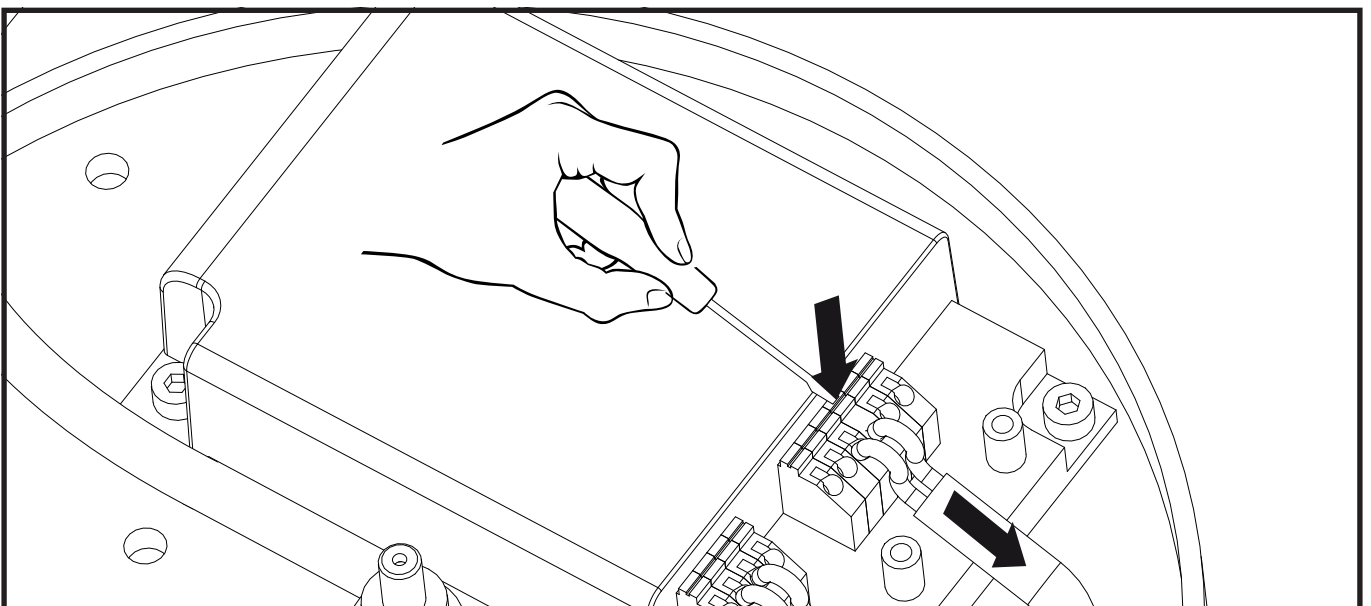
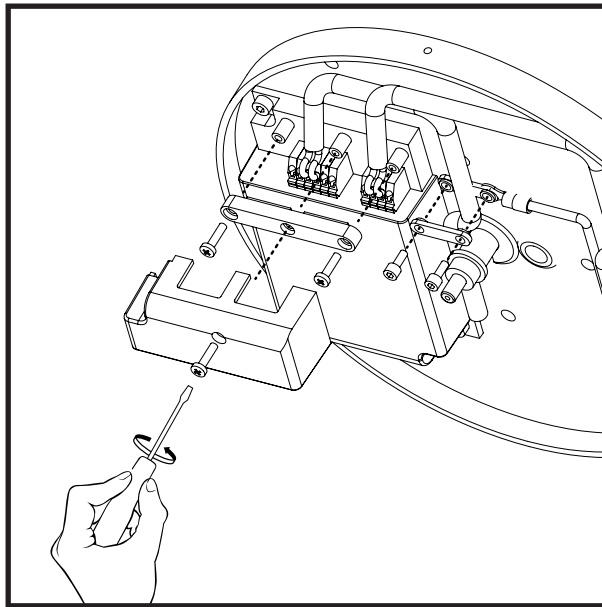
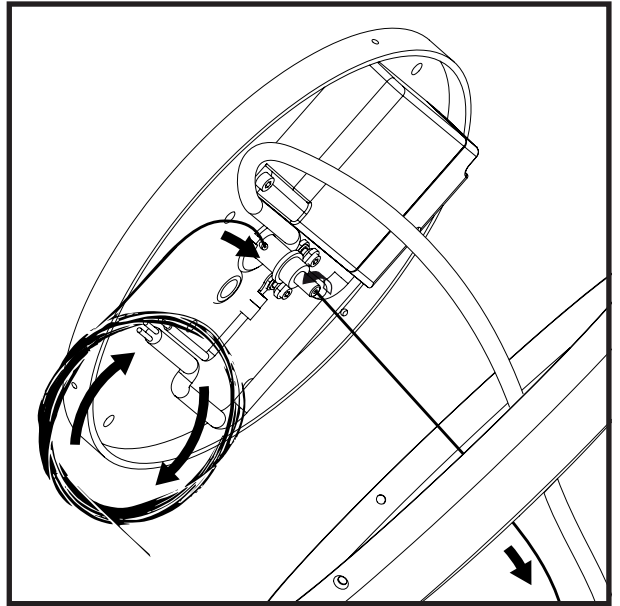
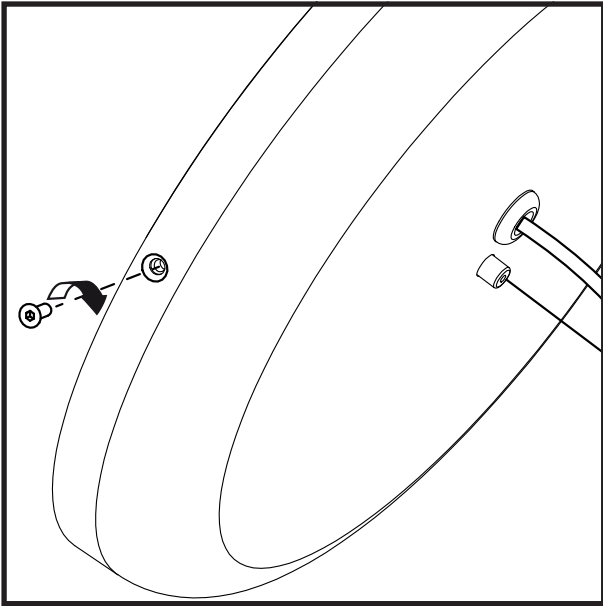

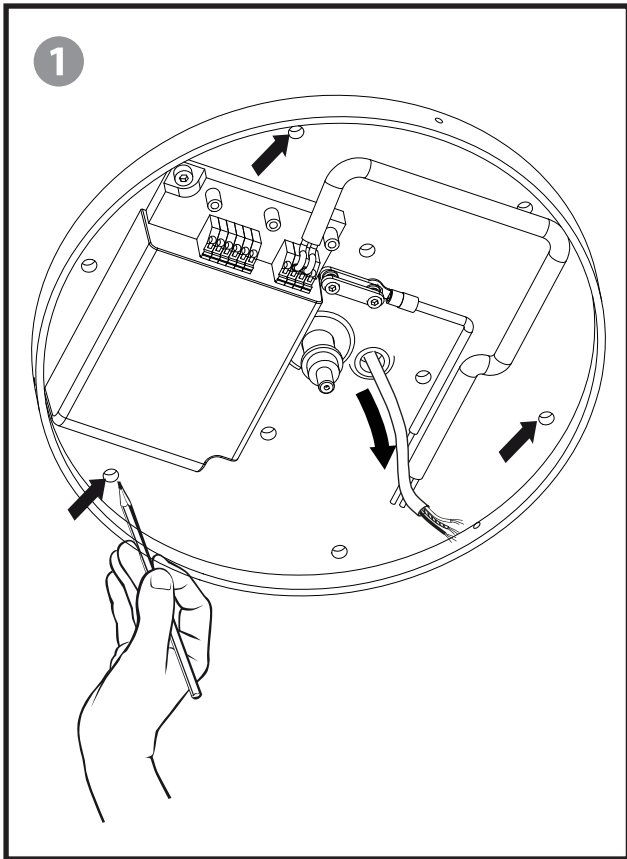

*** FOR "PENDANT 40" USA, SEE NEXT PAGE
POUR "SUSPENSION 40 USA" ALLER À LA PAGE
SUIVANTE**

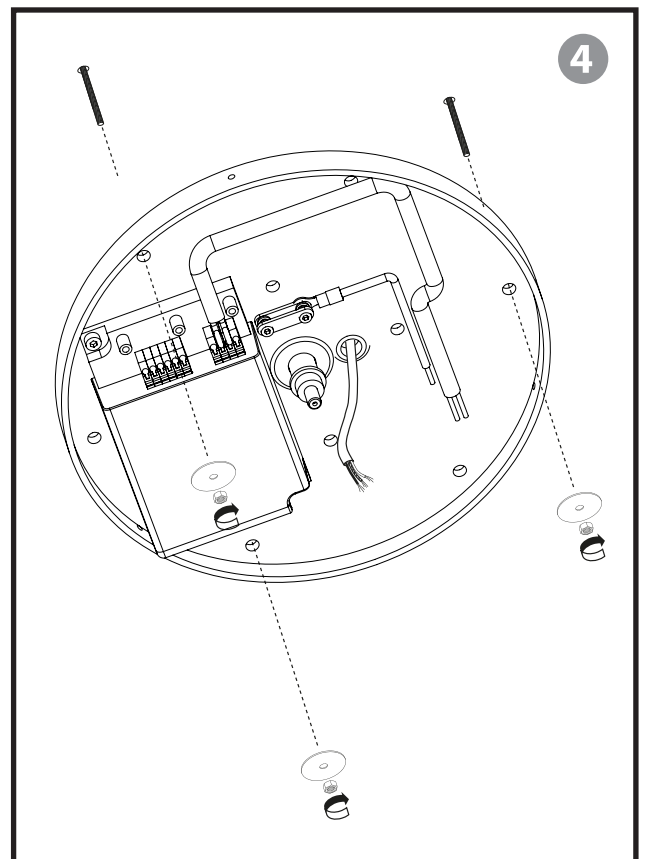
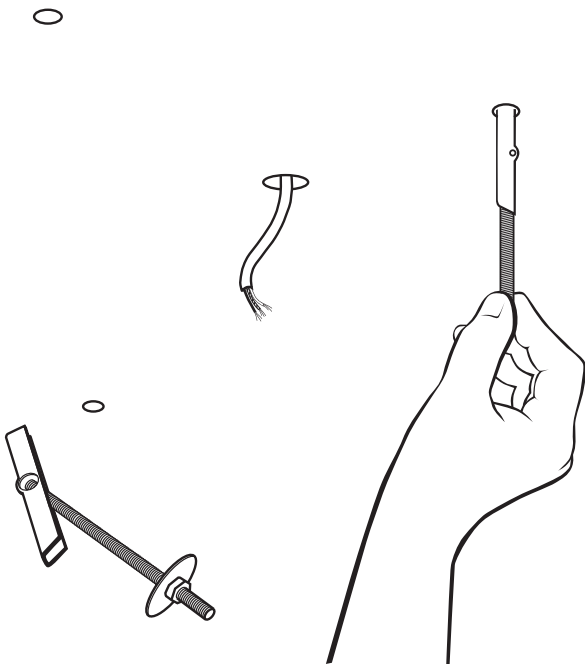
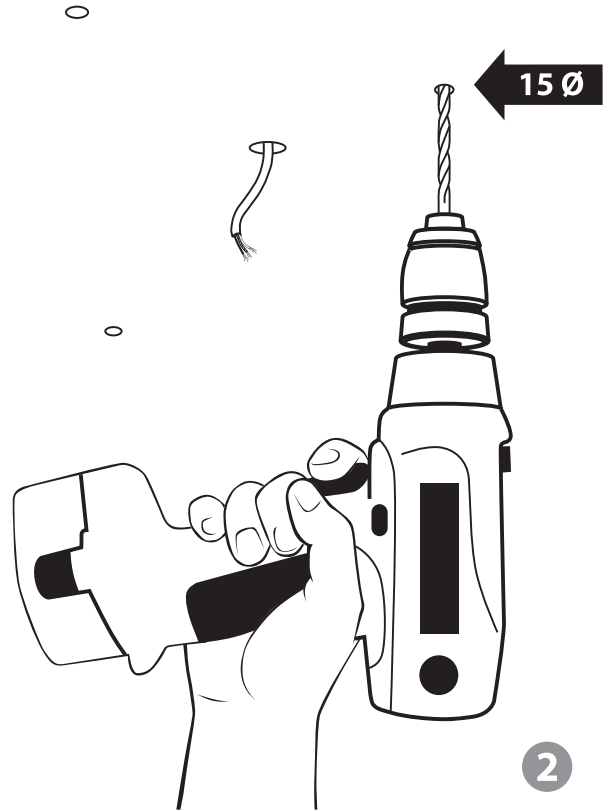

**PENDANT 40 USA
ONLY**

*SEULEMENT POUR
PENDANT 40 USA*

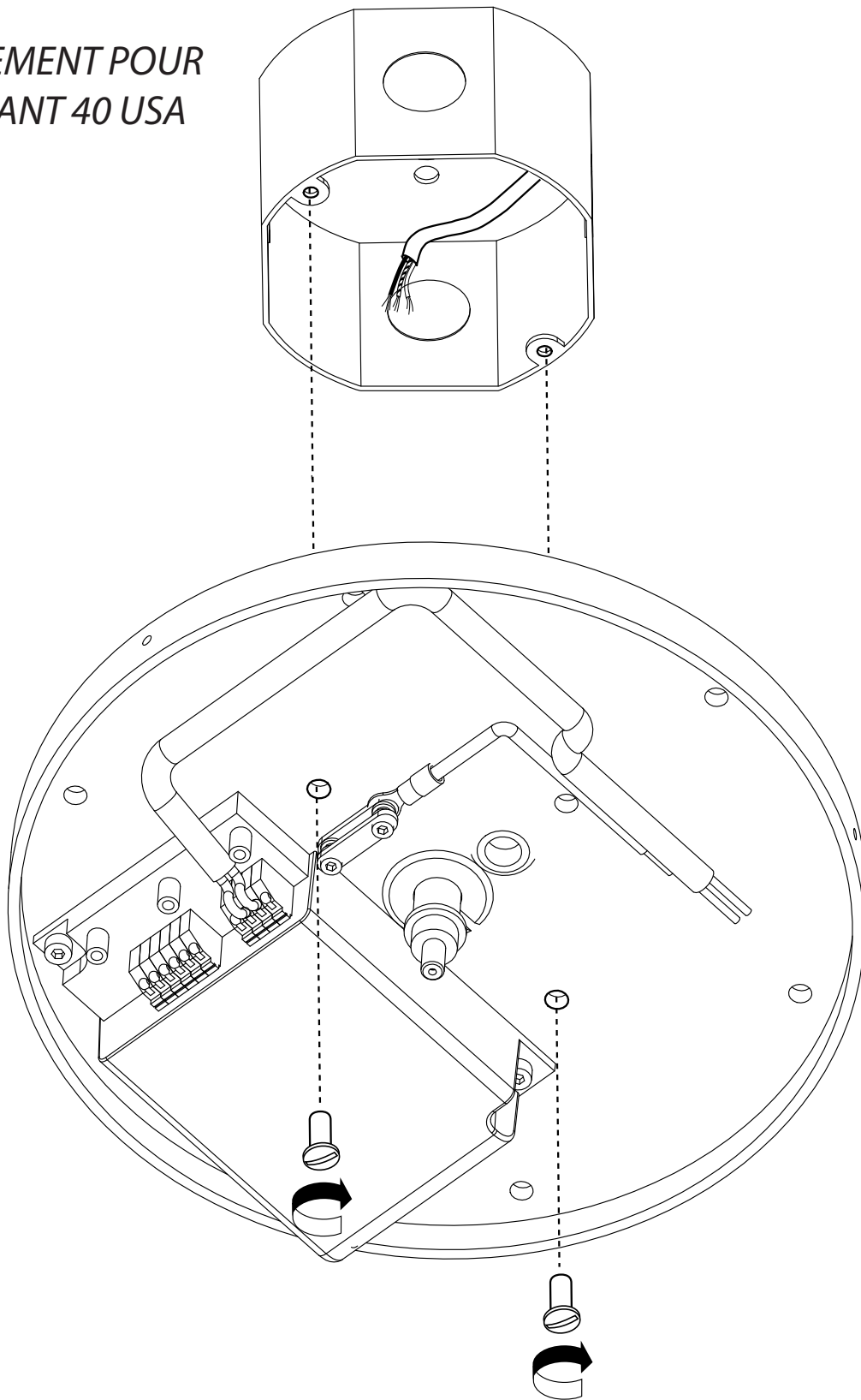

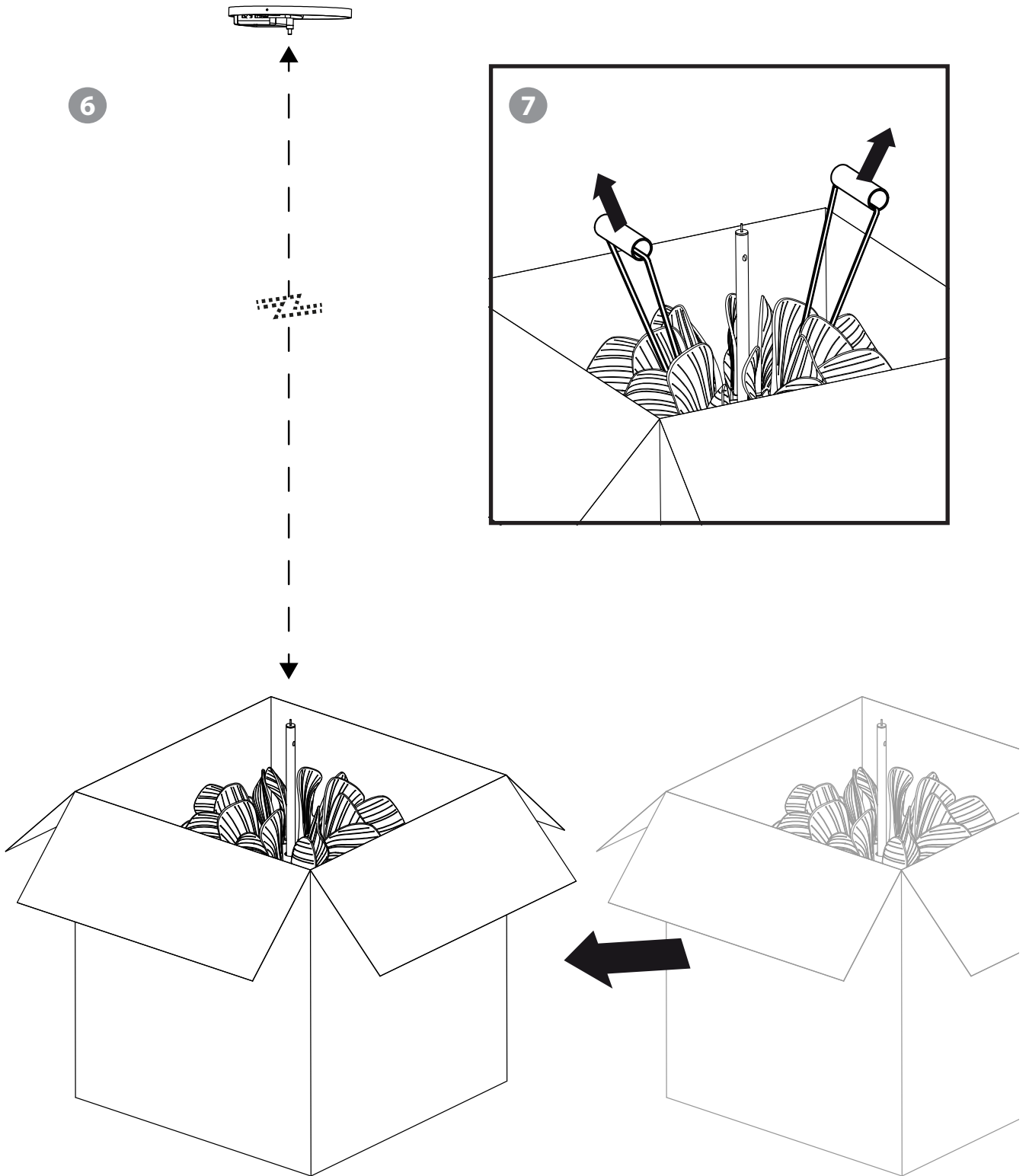

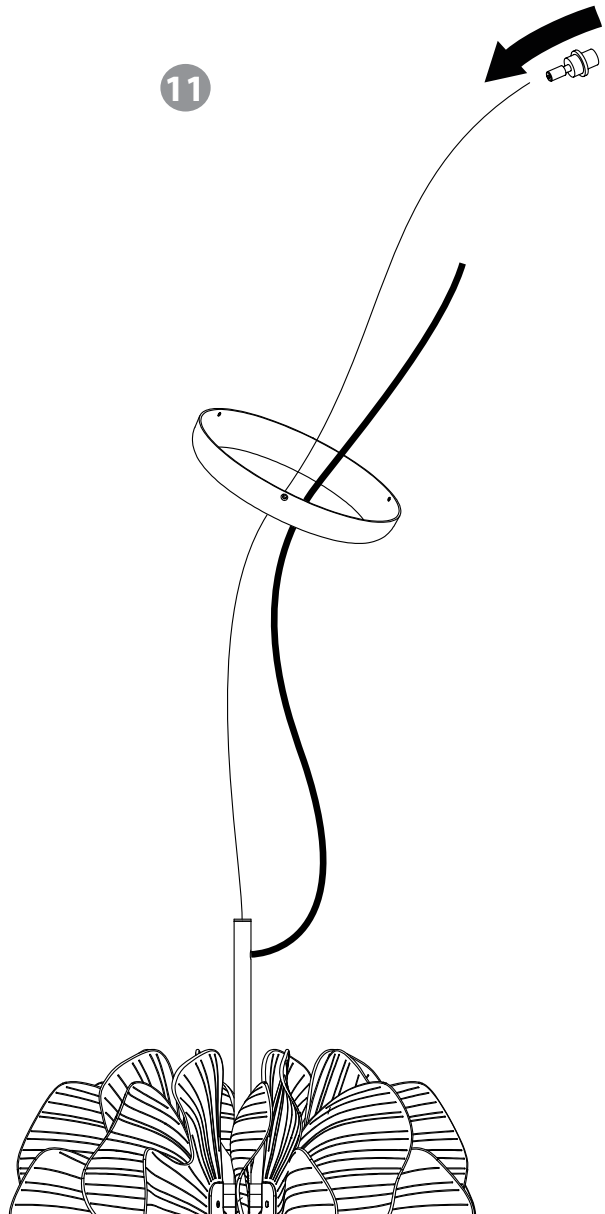
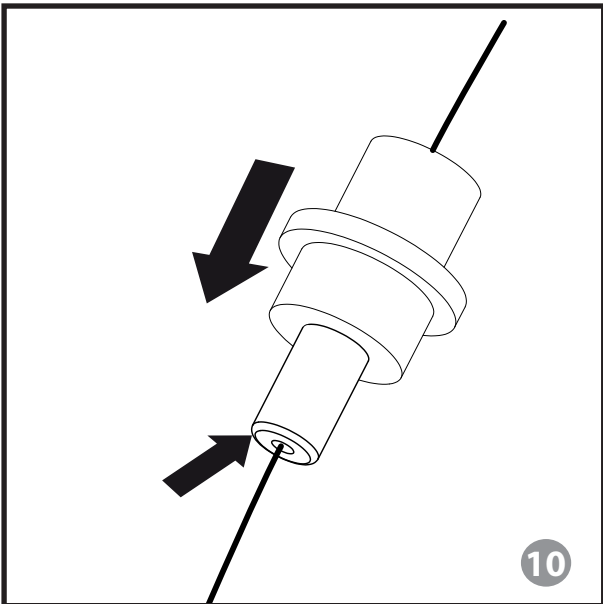
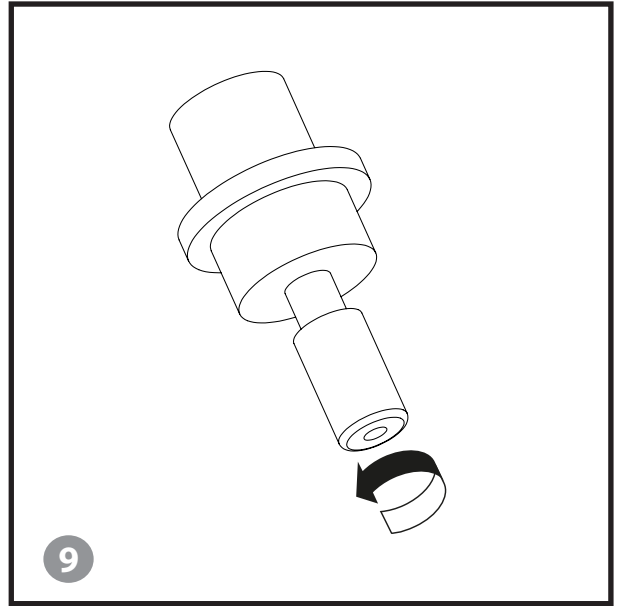
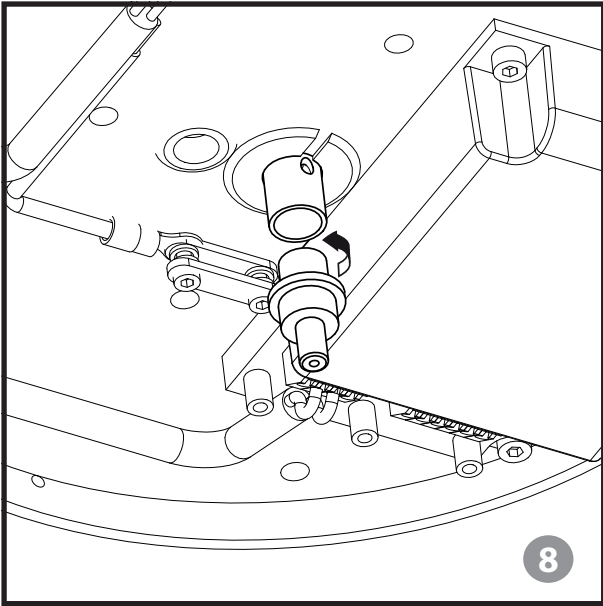

12



SON NECESARIAS DOS PERSONAS PARA COMPLETAR EL RESTO DE PASOS

FURTHER STEPS NEED TWO PEOPLE TO BE COMPLETED

DEUX PERSONNES SONT NÉCESSAIRES POUR COMPLÉTER LE RESTE DES ÉTAPES

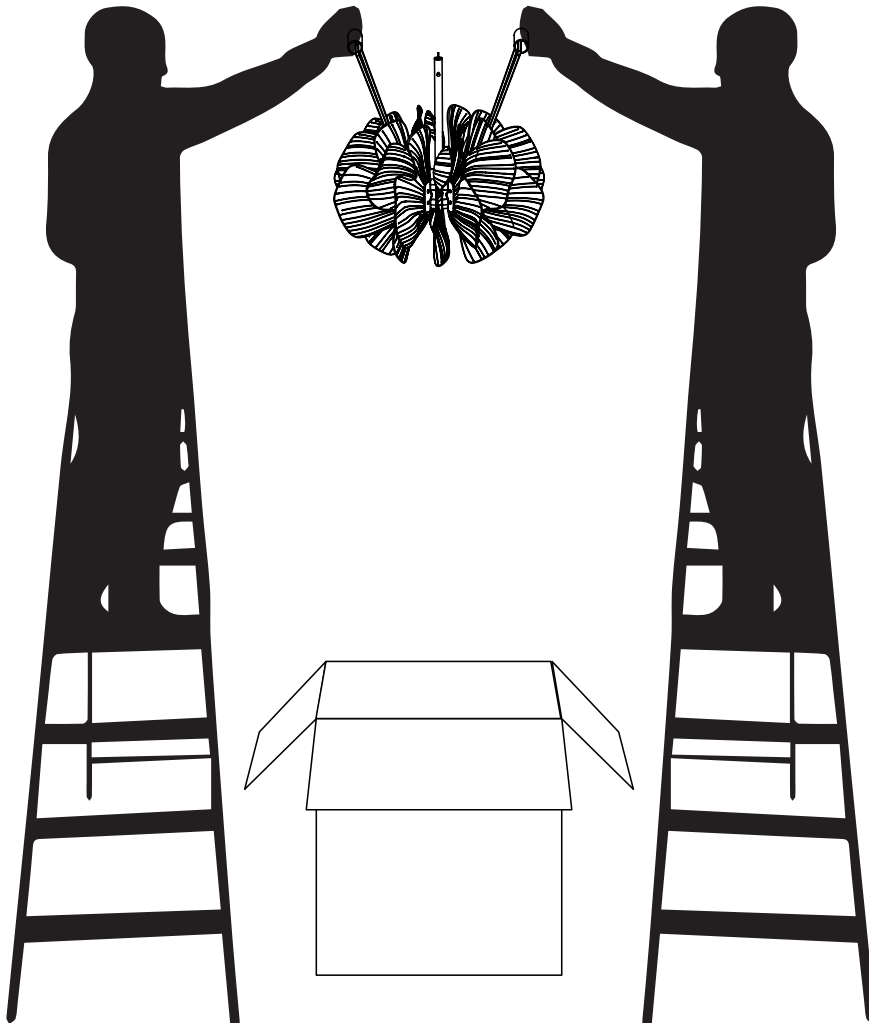

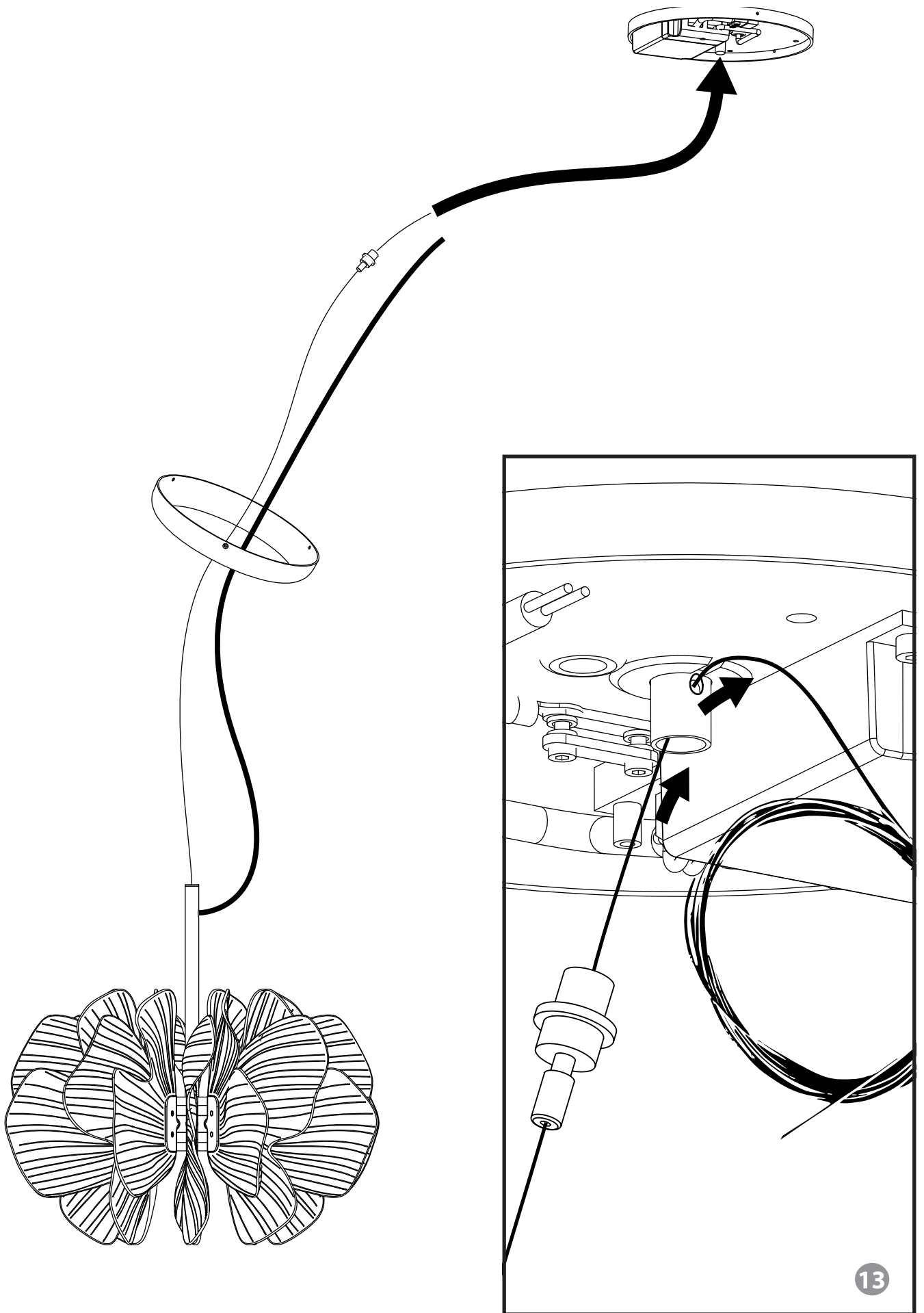

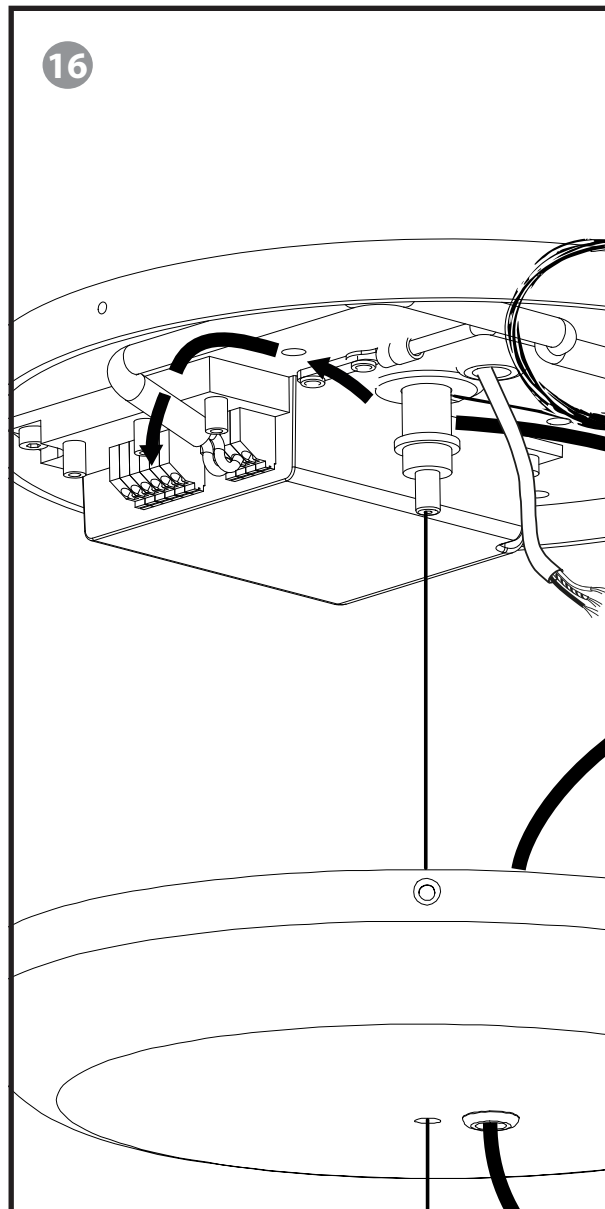
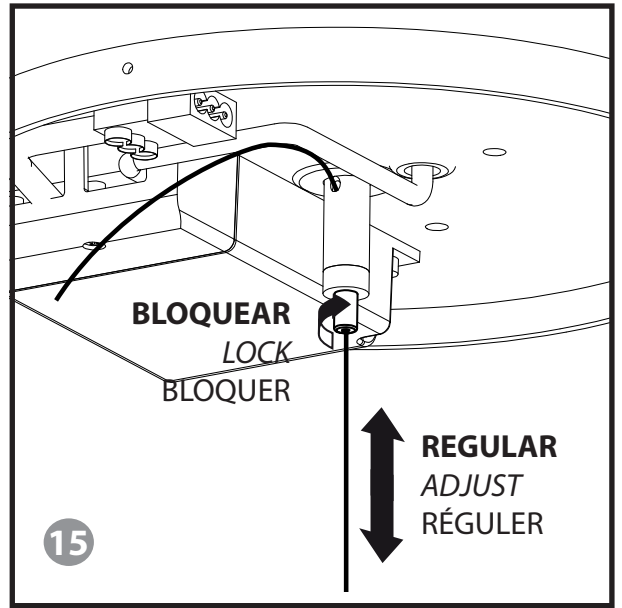
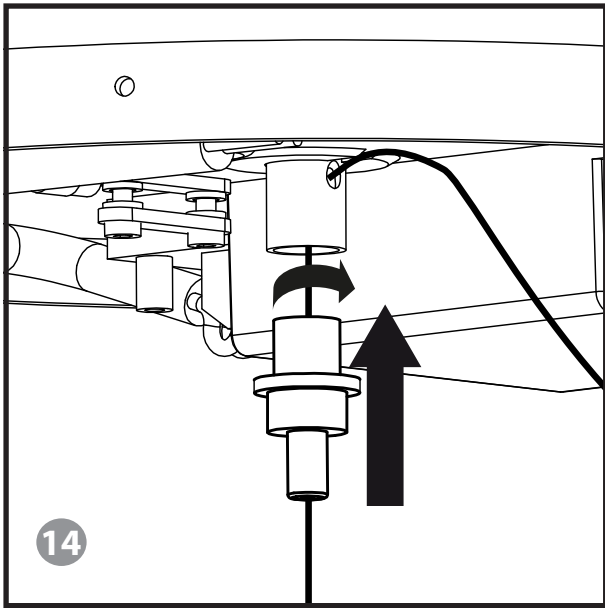

ANTES DE REALIZAR LA CONEXIÓN
BEFORE MAKING THE CONNECTION
AVANT DE FAIRE LA CONNEXION

Utilizar dimmer regulable mediante protocolo 0-10V Additive-Sourcing.

Use dimmer adjustable by protocol 0-10V Additive-Sourcing.

Utilisez le gradateur ajustable selon le protocole 0-10V Additive-Sourcing.

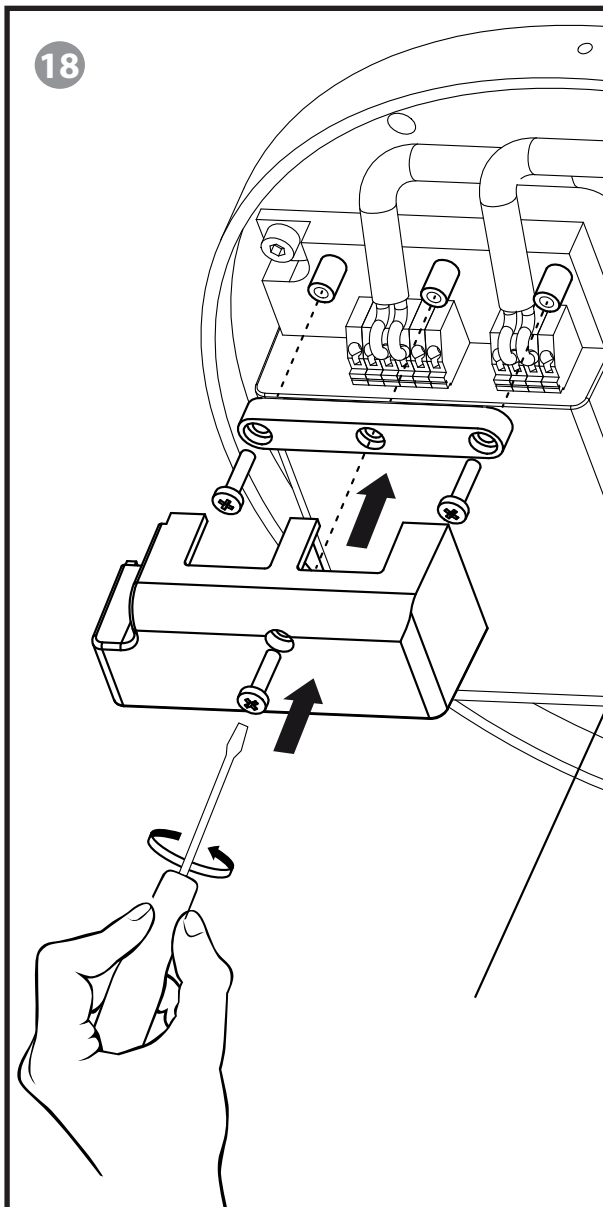
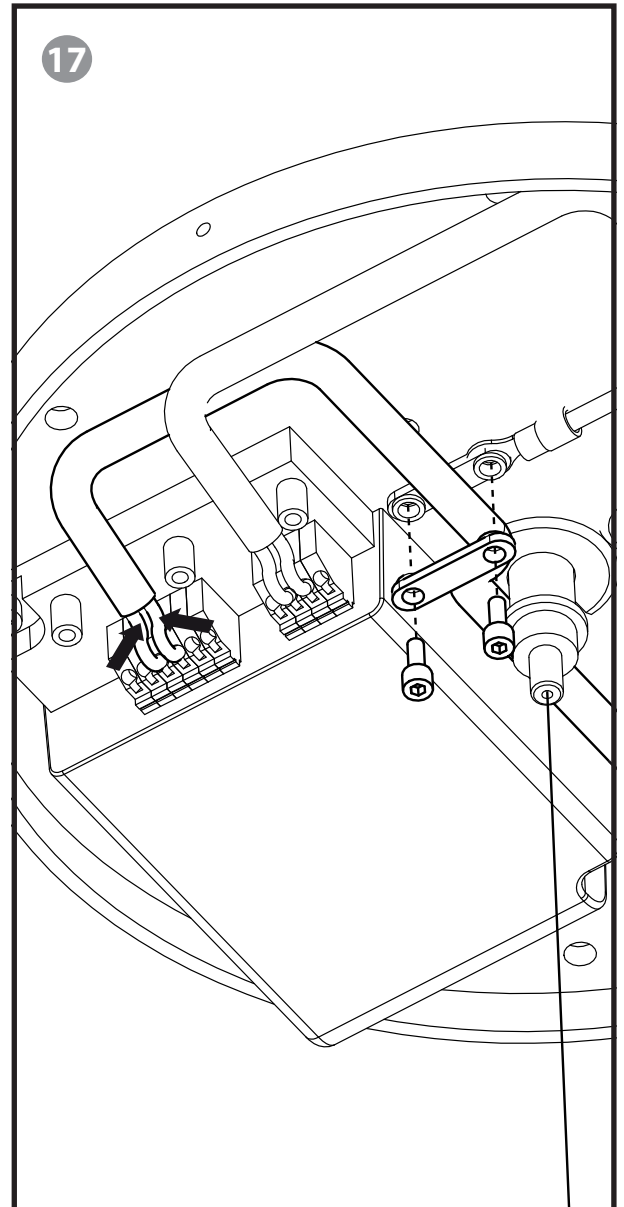

CÓDIGOS DE COLOR
COLOR CODES
CODE DE COULEUR

- **V0+**
TRANSPARENTE
CLEAR
CLAIR
- **V0-**
NEGRO
BLACK
NOIR

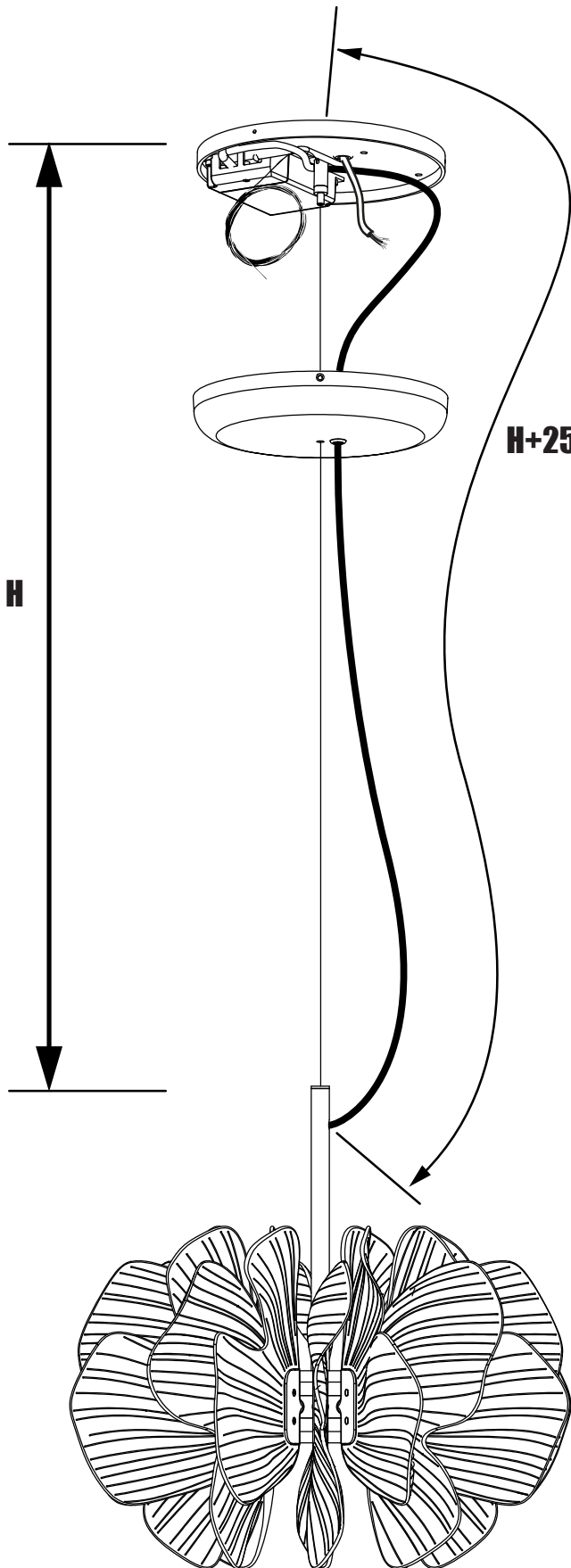

H+25cm

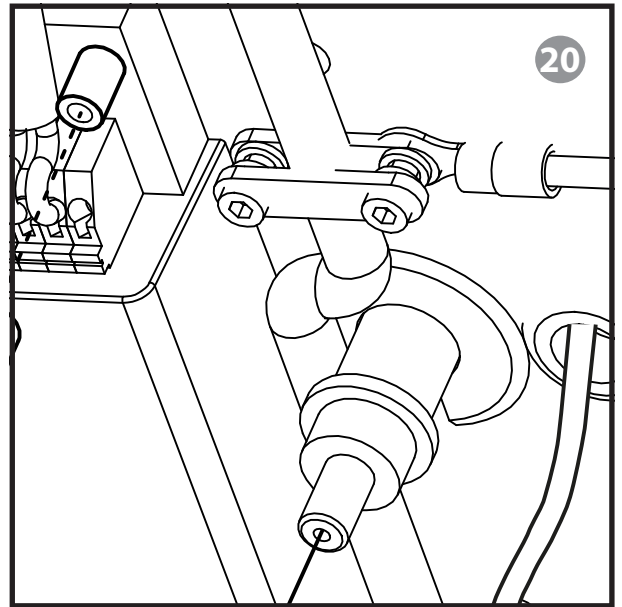
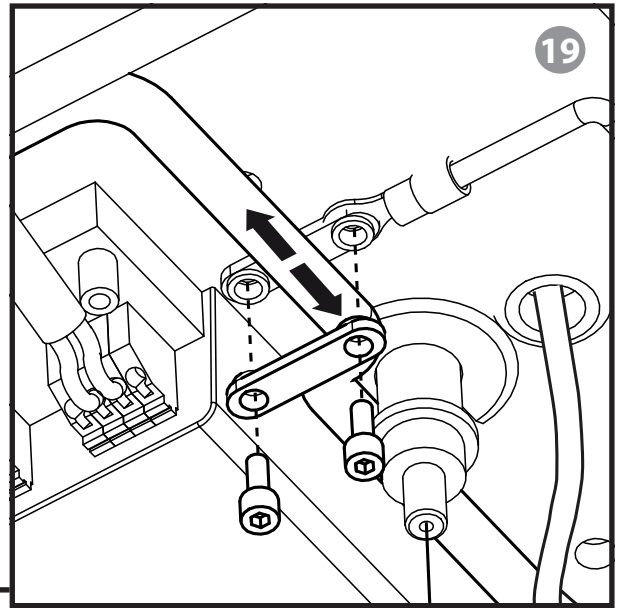

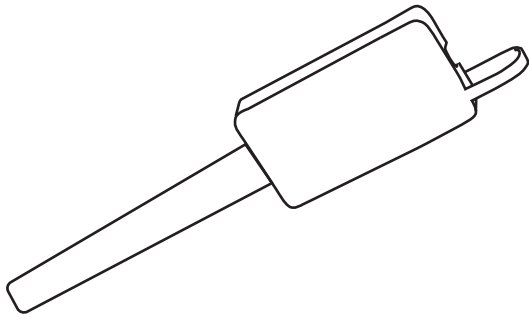

- **FASE / LINE / FASE»**
NEGRO (USA), MARRÓN (EUR)
BLACK (USA), BROWN (EUR)
NOIR (USA), MARRON (EUR)
- **NEUTRO / NEUTRAL / NEUTRE »**
BLANCO (USA), AZUL (EUR)
WHITE (USA), BLUE (EUR)
BLANC (USA), BLEU (EUR)
- **TIERRA / GROUND / TERRE**

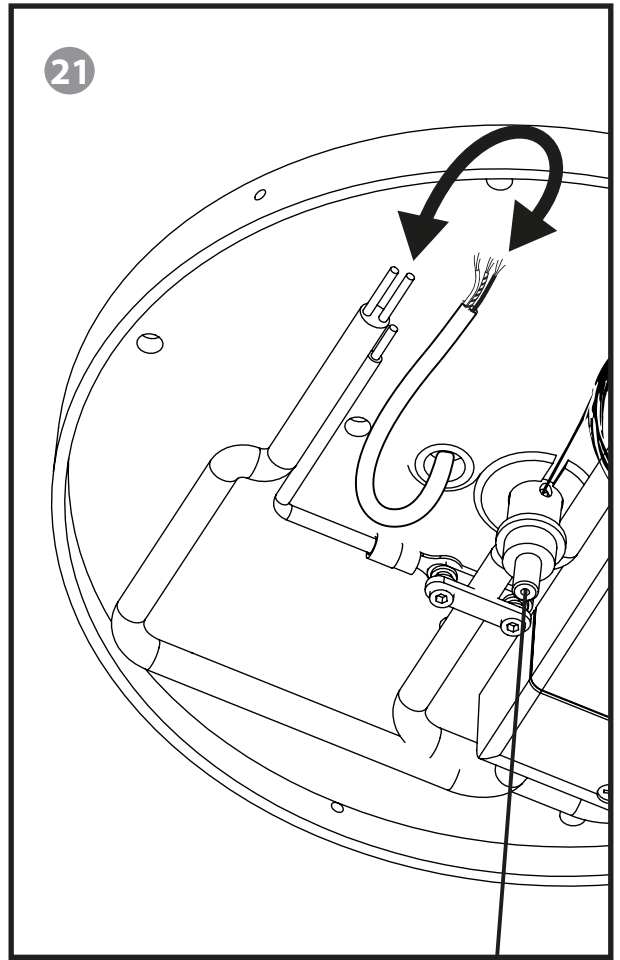

CÓDIGOS DE COLOR
COLOR CODES
CODE DE COULEUR

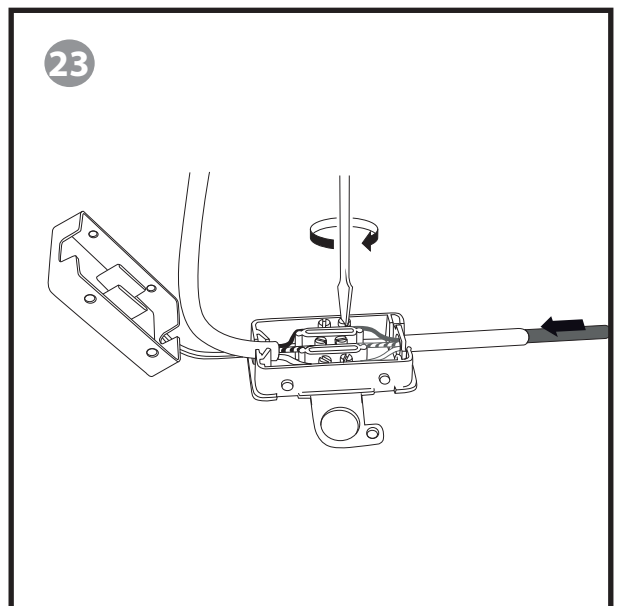
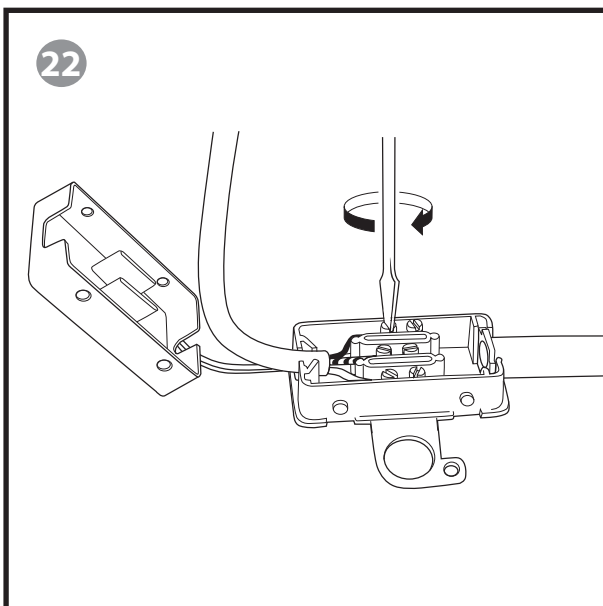

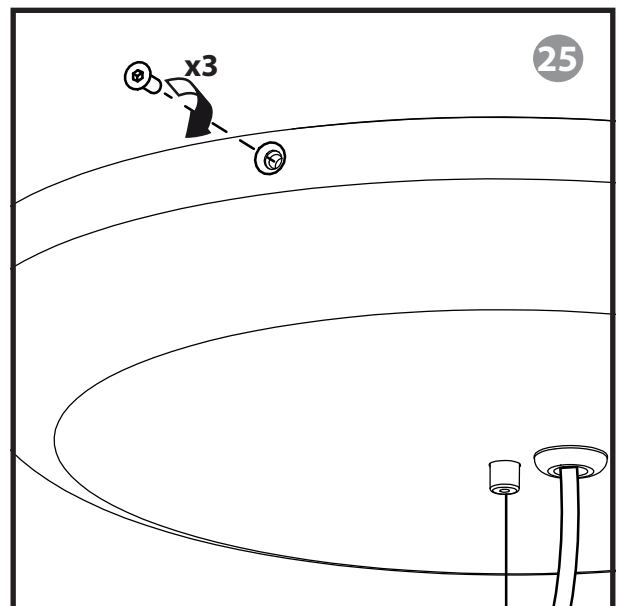
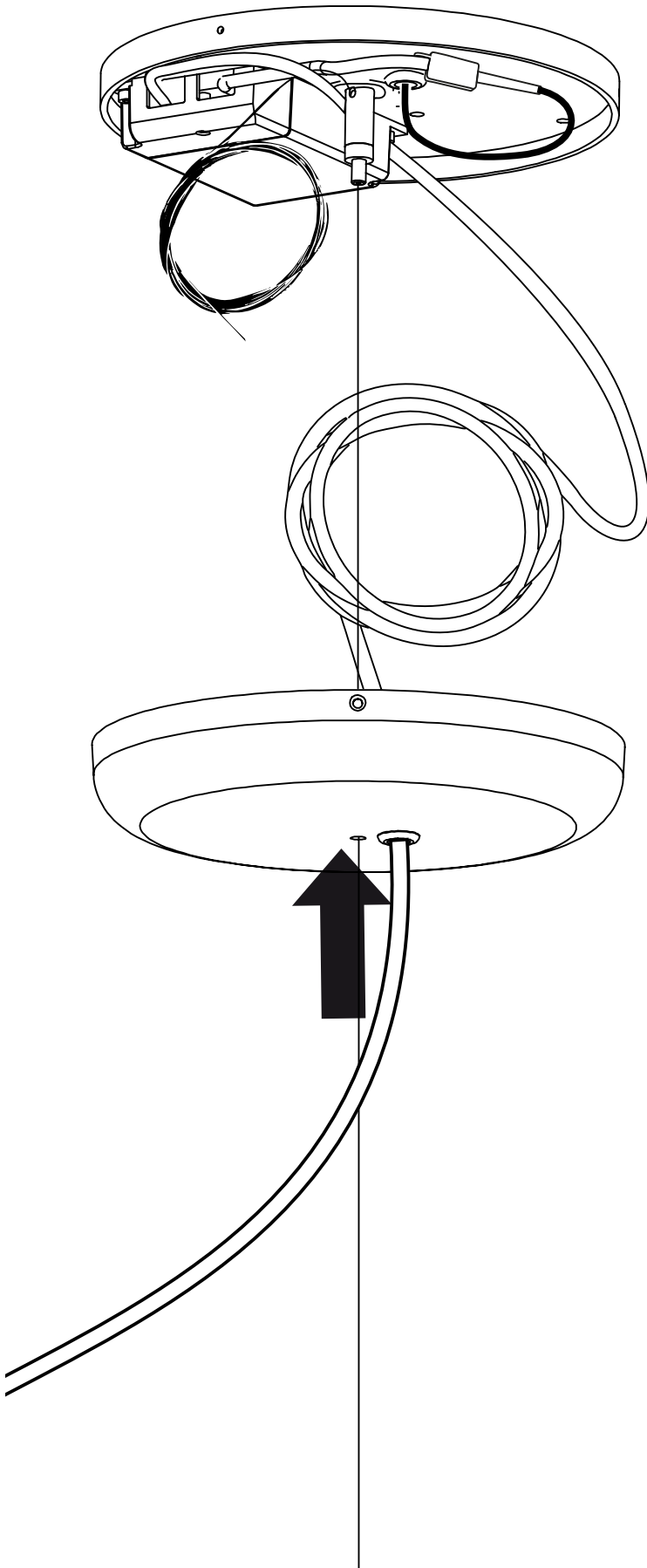



Lladró, S.A. Ctra Alboraya s/n - Polígono Lladró 46016 Tavernes Blanques - Valencia (Spain)