

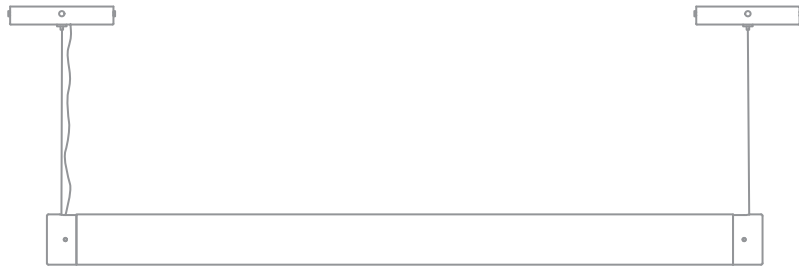

LEE BROOM



MARBLE TUBE LIGHT

CONTENTS

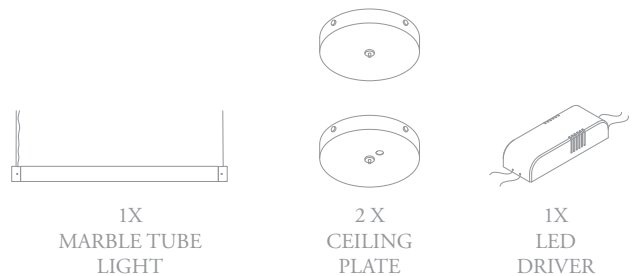

ATTENTION

- The marble tube light must be installed by a professional, qualified electrician
- Minimum of two people required for installation
- Ensure power supply is disconnected prior to installation
- This product is for interior use only and should be installed in a dry environment only
- Please use a universal leading or trailing edge dimmer switch which is suitable for low wattage LEDs
- LED light source supplied



28.8W
MAXIMUM
WATTAGE

THIS
PRODUCT
MUST BE
EARTHED

INPUT
110-130V
50-60 HZ

OUTPUT
24V

CARE AND CLEANING

- Only attempt to clean when the marble tube light is switched off
- Only use a non-abrasive, soft, dry cloth when cleaning the marble tube light

LEE BROOM

Lee Broom, Electra House, 93 Rivington St, London, EC2A 3AY
Tel + 44 (0)207 820 0742 info@leebroom.com www.leebroom.com

Lee Broom, Company Number 04393879, Registered Address 44 Southchurch Road, Southend on Sea, Essex SS1 2LZ

ASSEMBLY - MUST BE INSTALLED BY A PROFESSIONAL, QUALIFIED ELECTRICIAN

1. Unscrew the x4 screws from the x2 ceiling roses (1+2).
2. Separate the ceiling rose top plate from the base plate.
3. Terminate all mains wires.
4. Create one suitable hole (Ø8cm) in the ceiling positioned exactly where the electrical power supply is located for the marble tube light. The hole in the ceiling is to house the LED driver. Ensure the hole is big enough to fit the driver but not so big that you can not securely fix you ceiling rose.
5. Connect the mains live and earth wires to the correct input connections on the LED driver.
6. Mount the first back plate over the hole created to house the LED driver. Position the second back plate 80cm from the first back plate (measure from inside edge).
7. Set the tension cable to desired length on ceiling rose (2) and set power cable and tension cable length on ceiling rose (1). Only small adjustments can be made once installed.
8. Restrain power cable with cord restraint provided once the height is set.
9. Connect marble tube light power cable to output connections on LED driver. Please note the white labeled cable connects to the positive (red) output and the clear cable connects to the negative (black) output.
10. Hide driver in ceiling.
11. Connect the mains earth wire to the earth tag in ceiling rose (1).
12. Lift the mable tube light into position and locate the base of the ceiling roses with top plates.
13. Use the provide screws to secure the ceiling rose to top plate ensuring all four screw in both ceiling roses are secure before letting go of the marble tube light.

1, 2.

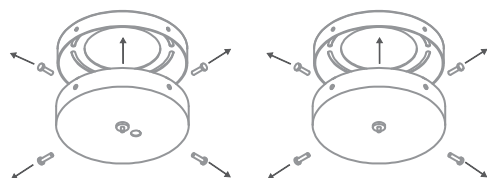

CEILING ROSE (1)

CEILING ROSE (2)

4.

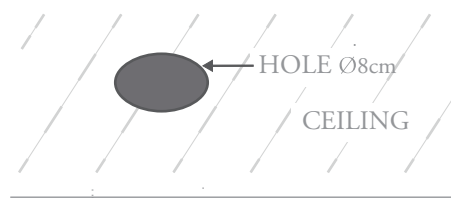

5.

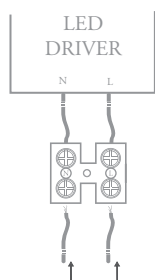

6.

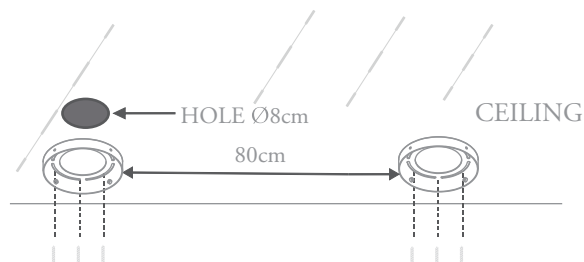

7.

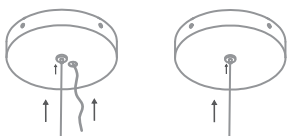

8.

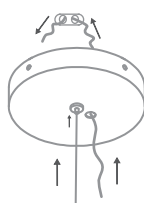

9.

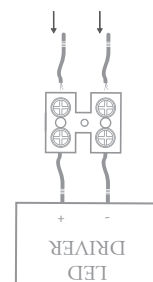

10.

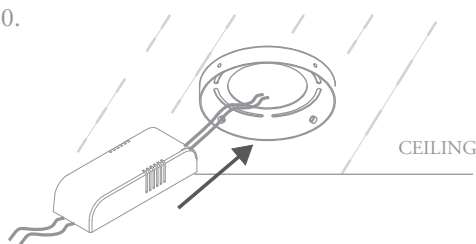

11.

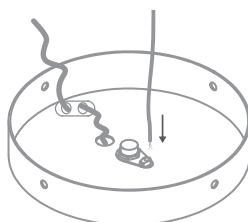

13.

