

LEE BROOM

CRYSTAL BULB WALL LIGHT

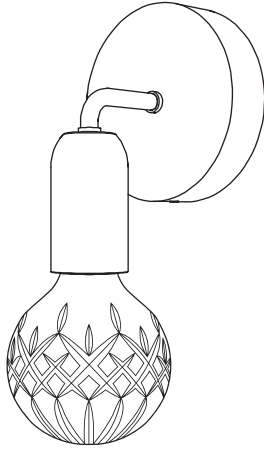

CONTENTS

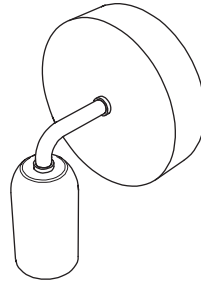

1 x Wall Fitting



1 x Allen Key

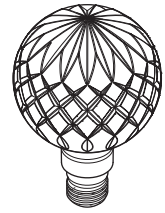

1 x Crystal Bulb &
E26 LED Bulb

ATTENTION! BEFORE YOU START

- The Crystal Bulb Wall Light must be installed by a qualified electrician.
- Ensure power supply is disconnected prior to installation.
- This product is for interior use only and should be installed in a dry environment only.
- Bulb is supplied.
- When switched on the Crystal Bulb Wall Light may become hot.
- Please read the instructions carefully before you commence install and retain them for future reference.

ASSEMBLY - please see associated diagrams overleaf

TERMINATE ALL MAINS WIRES BEFORE INSTALLATION

1. Unscrew and remove the grub screw from the side of the wall fitting by using the Allen key supplied. Ensure to keep the grub screw safe for reassembly.
2. Separate the back plate from the wall fitting by turning the back plate anti-clockwise and pull apart.
3. Mount the back plate to the required position on the wall. Always use the appropriate fixing for the wall material you are fixing to. Fixings not supplied.
4. Make electrical connections to the correct wires using the wire connectors provided.
5. Reassemble the wall fitting to the back plate. First locate the pin inside the wall fitting into the slot of the back plate.
6. (A) Turn whole fitting clockwise until the holes on wall fitting and back plate align. (B) Insert and screw hex socket screw into side of the wall fitting ensuring it is fixed securely.
7. Finally screw the Crystal Bulb unit into the wall fitting.

BULB REPLACEMENT

- Please visit WWW.LEEBROOM.COM to purchase replacement E26 2w LED Bulbs.
- DO NOT use with a halogen bulb.
- Maximum wattage 2w LED, 110-130v.
- Make sure the Crystal Bulb Wall Light is switched off and ensure the Crystal Bulb and E26 2w LED Bulb has cooled down before handling.
- To replace bulb:
 - i. Unscrew the Crystal Bulb unit from the wall fitting.
 - ii. Unscrew the E26 2w LED Bulb from the Crystal Bulb globe.
 - iii. Screw new E26 2w LED Bulb into the Crystal Bulb globe.
 - iv. Finally screw the Crystal Bulb unit back into the wall fitting.

CARE AND CLEANING

- Only clean when the Crystal Bulb Wall Light is switched off.
- Please allow a suitable cooling period before cleaning.
- Only use a non-abrasive, soft, dry cloth when cleaning the Crystal Bulb Wall Light.

For more information please contact:

US & Canada Inquiries: +1 212 804 8477 - 34 Greene Street, New York, NY 10013 - sales@leebroom.com

UK & Global Inquiries: +44 207 820 0742 - 95 Rivington Street, London, EC2A 3AY - info@leebroom.com

WWW.LEEBROOM.COM



ASSEMBLY

1.

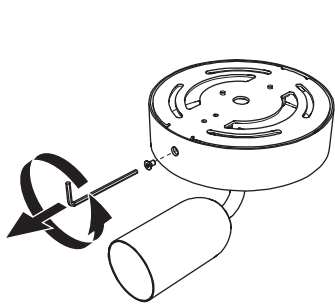

2.

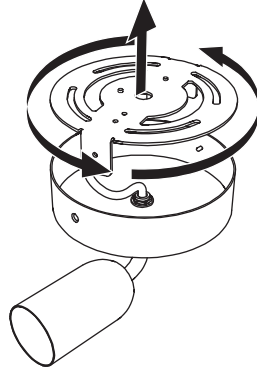

3.

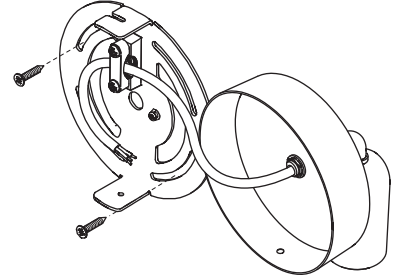

4.

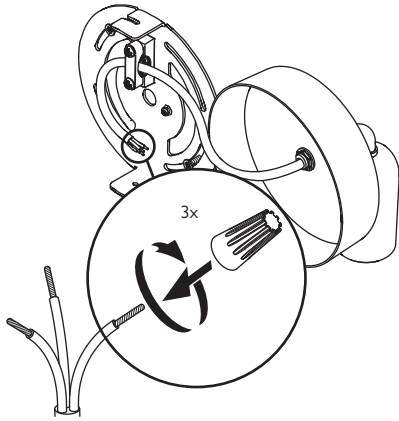

5.

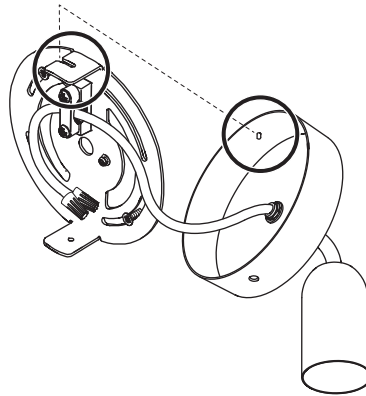

6.

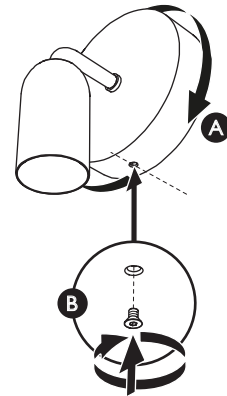

7.

BULB REPLACEMENT

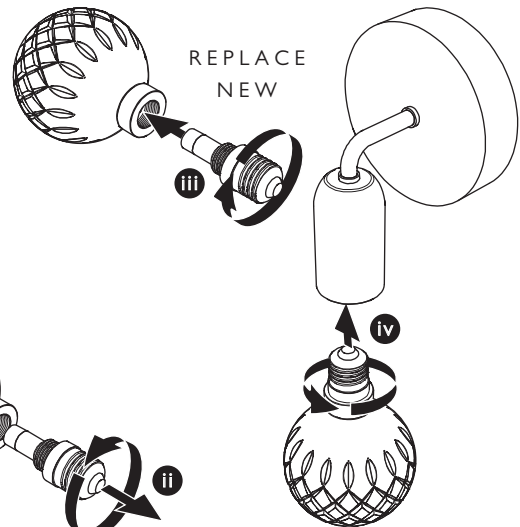
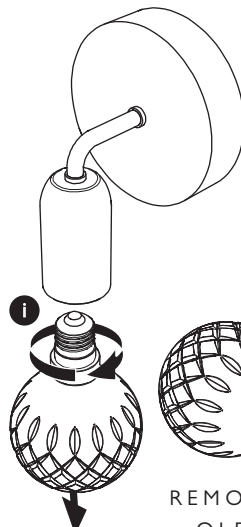
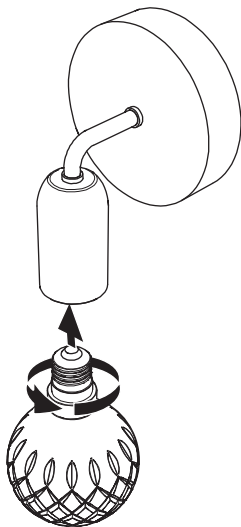

For more information please contact:

US & Canada Inquiries: +1 212 804 8477 - 34 Greene Street, New York, NY 10013 - sales@leebrook.com

UK & Global Inquiries: +44 207 820 0742 - 95 Rivington Street, London, EC2A 3AY - info@leebrook.com

WWW.LEEBROOM.COM

