

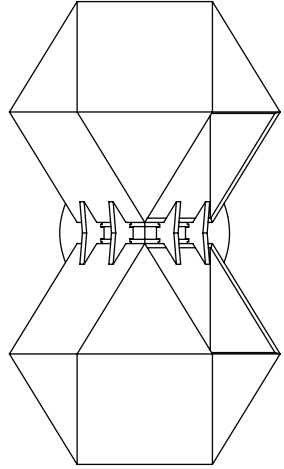

FILE#: E356487

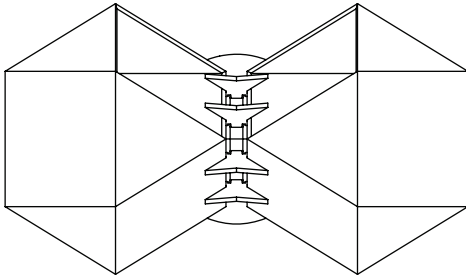

WELLES Glass

DOUBLE SCONCE

Installation Guide

- Certified electrician recommended for electrical installation.
- Terminal Block not included. Installation may require advice from a qualified person.
- The light source contained in this luminaire shall only be replaced by the manufacturer or his service agent or a similar qualified person. Contact manufacturer for service.
- For all LED fixtures, use only with class 2 power unit.

***IMPORTANT: Please provide email confirmation that your order and its related components have been received in their entirety and in good condition. Failure to do so within 7 days of delivery will waive all product warranties.**

GABRIEL SCOTT

EST. 2012



Provided Supplies:

- Welles Glass volumes
- Universal T-bar
- Installation Screws
- LED Driver
- Spare LED chip

Required Tools:

- Screwdriver
- 4x 2-pole Wiring Terminals, screw or screwless, 12-18AWG (1.0-2.5mm²), rated for 600V, 15A - EX: WAGO 222-412
- Requires LED driver; Input: Local Line Voltage, Output 12Vdc SELV, 5A, Max 60 Watt, Class 2 LED Driver.

STEP
1

Shut-down associated electrical breaker and wire LED driver to power source. Then secure driver in junction box using provided universal T-bar.

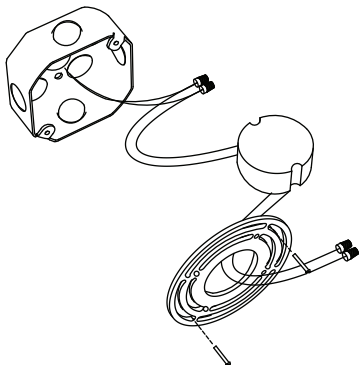

STEP
2

Connect exposed wire leads from LED driver to Welles Glass Double Sconce, on Gabriel-Scott fixtures the Black wire is positive (+) and the white is neutral (-). Once connected attach the Double Sconce and canopy to the already installed universal cross bar and tighten firmly.

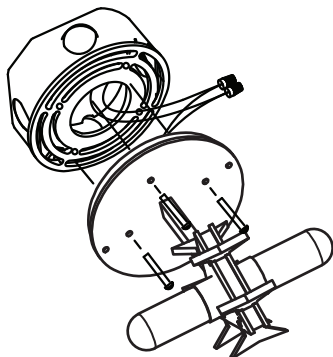

STEP
3

Once the fixture is mounted on the wall, remove the glass retaining rings from the fixture. To install the Welles Glass volumes to the fixture, slide the glass over the LED bulb and thread the glass retaining ring onto the fixture as demonstrated below.

Note:

The orientation of the large square access hole is up to the user. Either towards the wall, ceiling or floor.

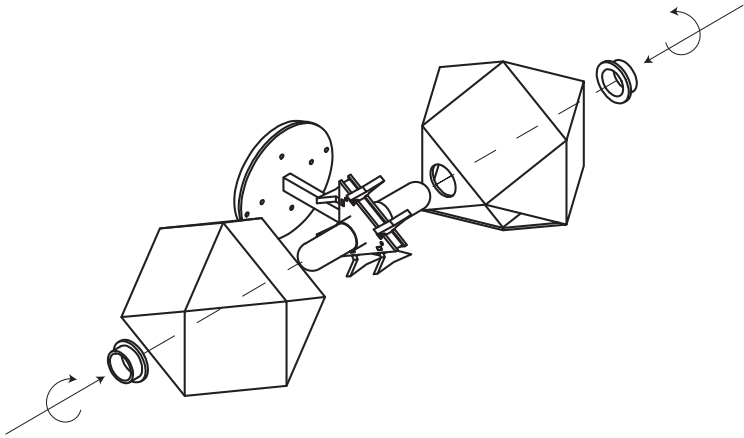

Exploded view of Welles Glass Double Sconce installation.

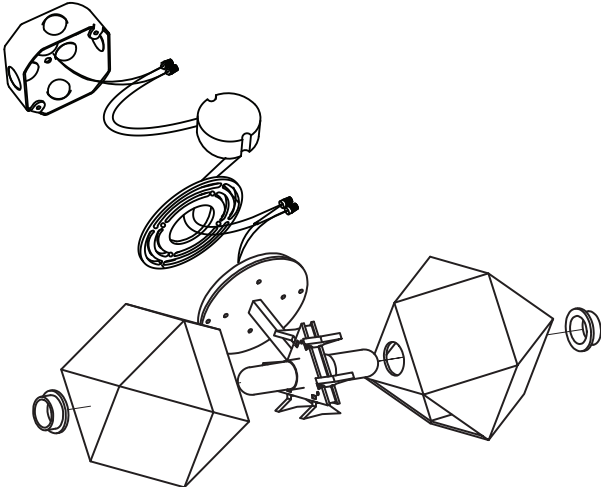



e: info@GabrielScott.com

t: (646) 783-3770