

# FLOS

 FU374400 Glass

## Luce Orizzontale S2

Designed by Ronan & Erwan Bouroullec, 2022

145W - 6682lm - 2700K - CRI> 95

Suspended lamp consisting of interconnected glass modules that reach a length of 1.66 mt. (S1) 2.07 mt. (S2) 2.49 mt. (S3) with 2.70 m suspended power cable. The cylindrical transparent glass modules are created through an artisanal process by pouring the glass into a rotating mold to obtain an exclusive finish that makes each single piece unique. Internal structure in polished extruded aluminum equipped with two linear LED modules for direct and indirect lighting downwards. The modules can be easily removed and replaced in case of maintenance. The power supply unit and the Dali Dimmer are located within the ceiling rose while a touch control button, positioned on one end of the product, allows the luminaire to be controlled in three different modes. Control options available: TOUCH\_ Features direct control via the touch button on the lamp. This option allows to dim and adjust the light intensity of both the up and down emission (individually or combined) from 10% to 100%. PUSH&TOUCH\_ Features remote on/off control via Push button as well as dim and adjustability of the light intensity of both the up and down emission (individually or combined) from 10% to 100% through the touch button integrated on the lamp. DALI&TOUCH\_ Features on/off control as well as dim and adjustability of the light intensity of both the up and down emission (individually or combined) from 10% to 100% through the touch button integrated on the lamp and remotely via DALI DT6.

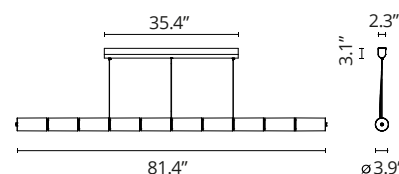

### Download

Mounting instructions



### Photometric Files

ULD



### Technical Drawings

2D



3D



Are you a professional and your project needs consulting and support?

BOOK AN APPOINTMENT

## Main specifications

EAN	8059607049976
Mounting	Suspension
Environments	Indoor dry location
Light Source Type	LED
Light sources included	Yes
LED type	LED Module
Power (W)	145
System flux (lm)	6682

## Physical

Color	Glass
Length (in)	81.57
Cord color	Clear
Cord length (in)	106.299
Canopy color	White
Canopy length/diameter (in)	35.433
Canopy width (in)	2.402
Canopy height (in)	3.071
Net weight (lb)	76.06
Package volume (in)	13349.61
IP internal	20

## Ecodesign and Energy Labelling

This product contains a light source of energy efficiency class F

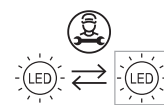

Replaceable (LED only) light source by a professional

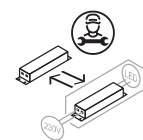

Replaceable control gear by a professional



## Photometric

Lighting type	Indirect, Direct
Light distribution	Symmetric
CCT (K)	2700
CRI>	95
Extreme cut off	No

## Electrical

Insulation class	I
Frequency (Hz)	50/60
Main voltage (Vac)	100-240
LED current (mA)	600
Driver	Integrated
Dimmable	Yes
Dimming type	Dimmer on board
Dimming interface	Dimmer Integrated

Spare Parts

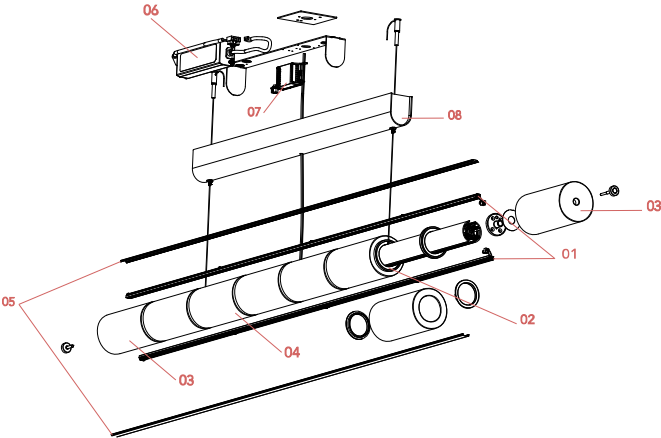

00.	Luce Orizzontale S2 UL Assembly Accesories kit	RF34057
01.	Led Board for Luce Orizzontale Suspension 2	RF3747300
02.	Suspensión Ring Wiring 4m for Luce Orizzontale	RF3746200
03.	Closed Glass Difusser for Luce Orizzontale	RF3746300
04.	Open Glass Difusser for Luce Orizzontale	RF3746400
05.	Linear Difusser Luce Orizzontale Suspension 2	RF3747200
07.	Luce Orizzontale Ceiling rose dimmer	RF36893
08.	Rose for Luce Orizzontale Suspension 1-Suspension 2 White	RF3746600



RF34057  
Luce Orizzontale S2 UL Assembly  
Accessories kit



RF3747300  
Led Board for Luce Orizzontale  
Suspension 2



RF3746200  
Suspensión Ring Wiring 4m for  
Luce Orizzontale



RF3746300  
Closed Glass Difusser for Luce  
Orizzontale



RF3746400  
Open Glass Difusser for Luce  
Orizzontale



RF3747200  
Linear Difusser Luce Orizzontale  
Suspension 2



RF36893  
Luce Orizzontale Ceiling rose  
dimmer



RF3746600  
Rose for Luce Orizzontale  
Suspension 1-Suspension 2  
White