

Instruction Manual

1. Model

This Instruction is for LED Module.

2. Specification

Ambient temperature for operation	-14° C to 35°C
LED	Warm white LED (3000K)
Battery	3.7V 4000mAh Li-ion
Charging time	Around 8 hours for full charging
Working time	4-10 hours depends on the lumen
Remote control	4~8 meters
IP Rating	IP65
Input	DC 5V 1A (Charger not supplied)

3. Warnings and Cautions

The remote control and USB cable are not waterproof and must be kept in a dry location at all times.

This product is not designed to be used in pools or ponds.

Never charge the product in a pool, water or rain; charge it in a dry, indoor location.

Disconnect the power supply from power outlet when not in use.

Do not stand, sit or jump on this product.

Keep the product away from chemicals and heat.

Do not attempt to open the product.

The product won't be under warranty if opened without permission.

The product can be only charged by a max. 5V output charger, if over 5V, the battery will be broken.

**Notice: All icons from this instruction are for reference only, please refer to the actual product for details.*

4. Operation

4.1 Product with Accessories



1X LED Module

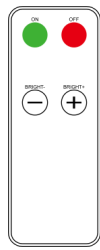

1X Remote control



1X DC USB cable



1X User manual

4.2 Charging your LED Module

The battery of this module is recharged by its cable supplied on a computer, or a max. DC 5V output charger not supplied.

Charge the product for at least 8 hours before using.

IMPORTANT

The module should not be in use while it is charging.

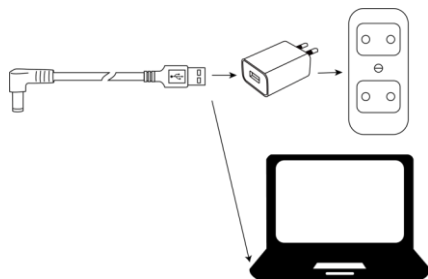

4.3 Turn your LED Module On and Off

Press and hold the ON/OFF switch for approx.

2~3 seconds to turn the light on or off.

Click ON/OFF switch to change the brightness by 25%,50%,75%,100% (max. 500lm)

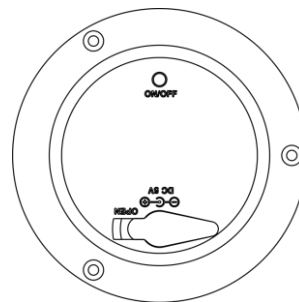

5. How to use remote

5.1 Button on remote

- ON: Press ON button to turn ON the product
- OFF: Press OFF button to turn OFF the product
- BRIGHT±: Change the brightness

Remove the small plastic sheet from the battery cover before using the remote control.

Please return this plastic sheet to remote control when not using to save battery power.

Notice: Each time you need to turn on product before activating remote control function.

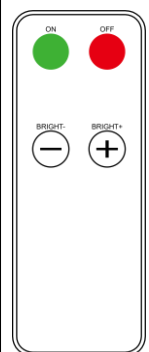

6. Maintenance for Product and Accessories

Cleaning: It is recommended that the product is turned off after using, rinsed using clean water and dried using a soft cloth.

When not using: Store these product out of reach of children and direct sunlight when not in use.