



# Dune Light™

The summit of simplicity. Inspired by one of nature’s purest forms, the Dune Light takes on the guise of earthy hills. The nesting mounds are available in three sizes (12”, 20” and 30” diameter) to create sculptural landscapes when installed in groups.

**Design**  
2016, Andrew Neyer

**Materials**  
Powder coated aluminum  
SVT power cord

**Dimensions**  
Small: 12” diameter, 5.2” H  
Medium: 20” diameter, 8.6” H  
Large: 30” diameter, 13” H  
8ft SVT cord (field cuttable)

**Specifications**  
Hardwired fixture  
Mounts to standard junction box  
120V / Medium base sockets

**Lighting**  
(1) 120V 60W E26 medium-base bulb (not included)  
Recommended bulb: G25

SKU	Color
DL-12-MSS	Moss
DL-12-SND	Sand
DL-12-DRT	Dirt
DL-12-STN	Stone
DL-12-NS	Night Sand
DL-20-MSS	Moss
DL-20-SND	Sand
DL-20-DRT	Dirt
DL-20-STN	Stone
DL-20-NS	Night Sand
DL-30-MSS	Moss
DL-30-SND	Sand
DL-30-DRT	Dirt
DL-30-STN	Stone
DL-30-NS	Night Sand

**Canopy Dimensions**  
5” Dia x 0.25” H



Pictured: DL-30-MSS, DL-20-MSS & DL-12-MSS

## DIMENSIONS

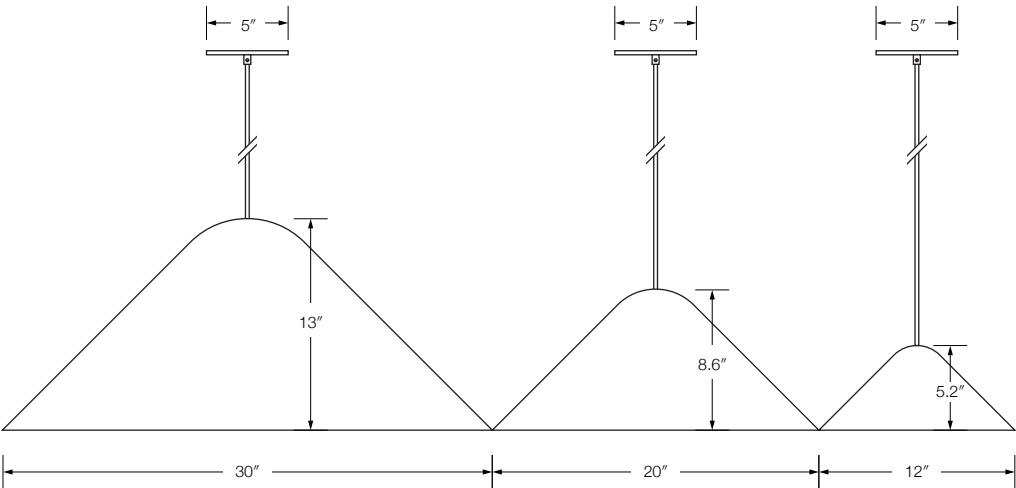

Measure twice, cut sheet once!

