

Cobra

by Innermost

SAFETY WARNINGS

Installation should only be undertaken by a qualified electrical engineer. If using the connector block provided this will need to be inserted into the wall void. To remove the outer backplate, simply unscrew and detach flat plate from wall bracket.

The light source contained in this luminaire is integrated and shall only be replaced by the manufacturer or his service agent or a similar qualified person.

TECHNICAL INFORMATION

Cobra Wall - Integrated LED Source,
Philips chip, chip life 40,000 hours
3W, 160lm, 3000K, CRI (Ra) 80
Beam Angle 160°

Universal Driver, 1.2 mA USB Charger,
touch ON/OFF Switch
Cosmetic Flat plate optional for EU

CLEANING AND CARE

Switch off the luminaire before cleaning.

To dust, use a non-abrasive cloth. If further cleaning is needed, wipe leather with a damp cloth using a mild soap. Avoid soaking. Avoid excessive heat and direct sunlight as these will dry the leather.



Innermost WEEE
registration number:
WEE/FH1713VS

innermost

COBRA WALL

WC078190XX



This luminaire
contains built-in
LED lamps

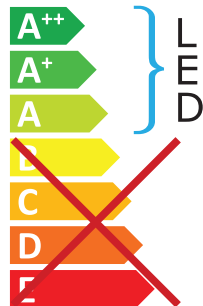

This lamp cannot be changed
in the luminaire.

874/2012

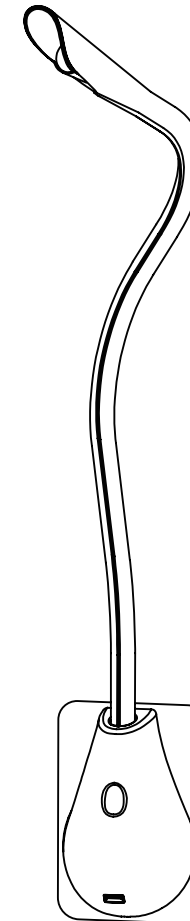

INSTALLATION GUIDE FOR :

Cobra Wall EU/UK

White - WC07819001
Brown - WC07819010

For further information, please contact:
info@innermost.net

www.innermost.net
OXO Tower Wharf Bargehouse Street London

innermost[®]

Cobra

by Innermost

innermost®

INSTALLATION TEMPLATE FOR:
COBRA WALL 90 UK/EU - WC078190XX

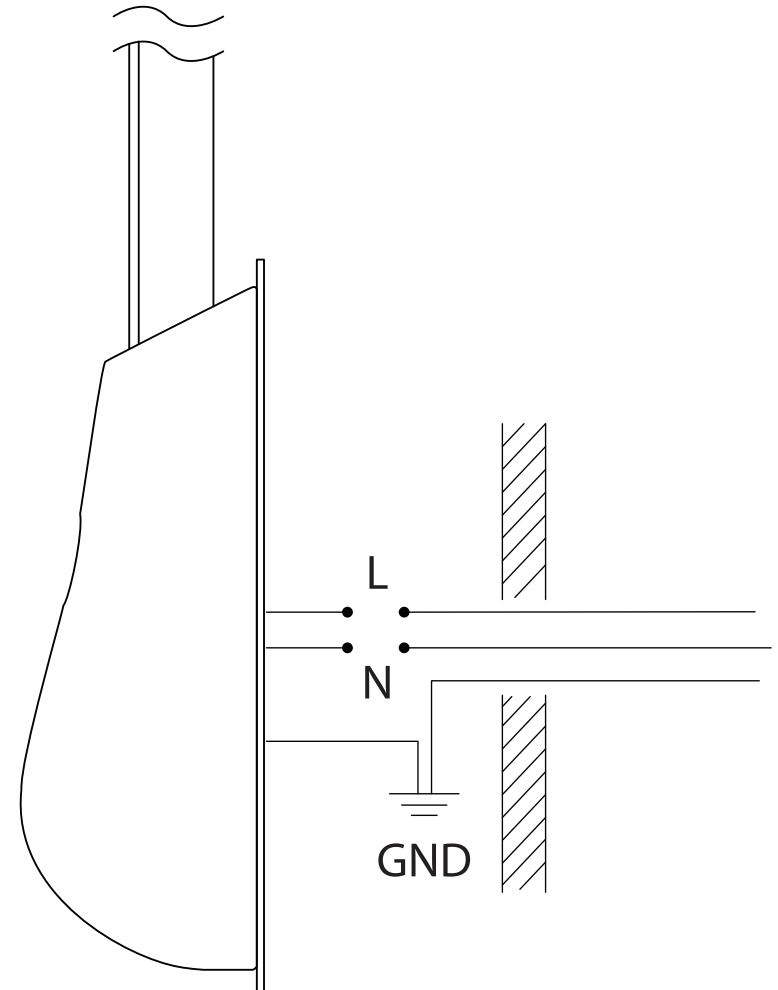

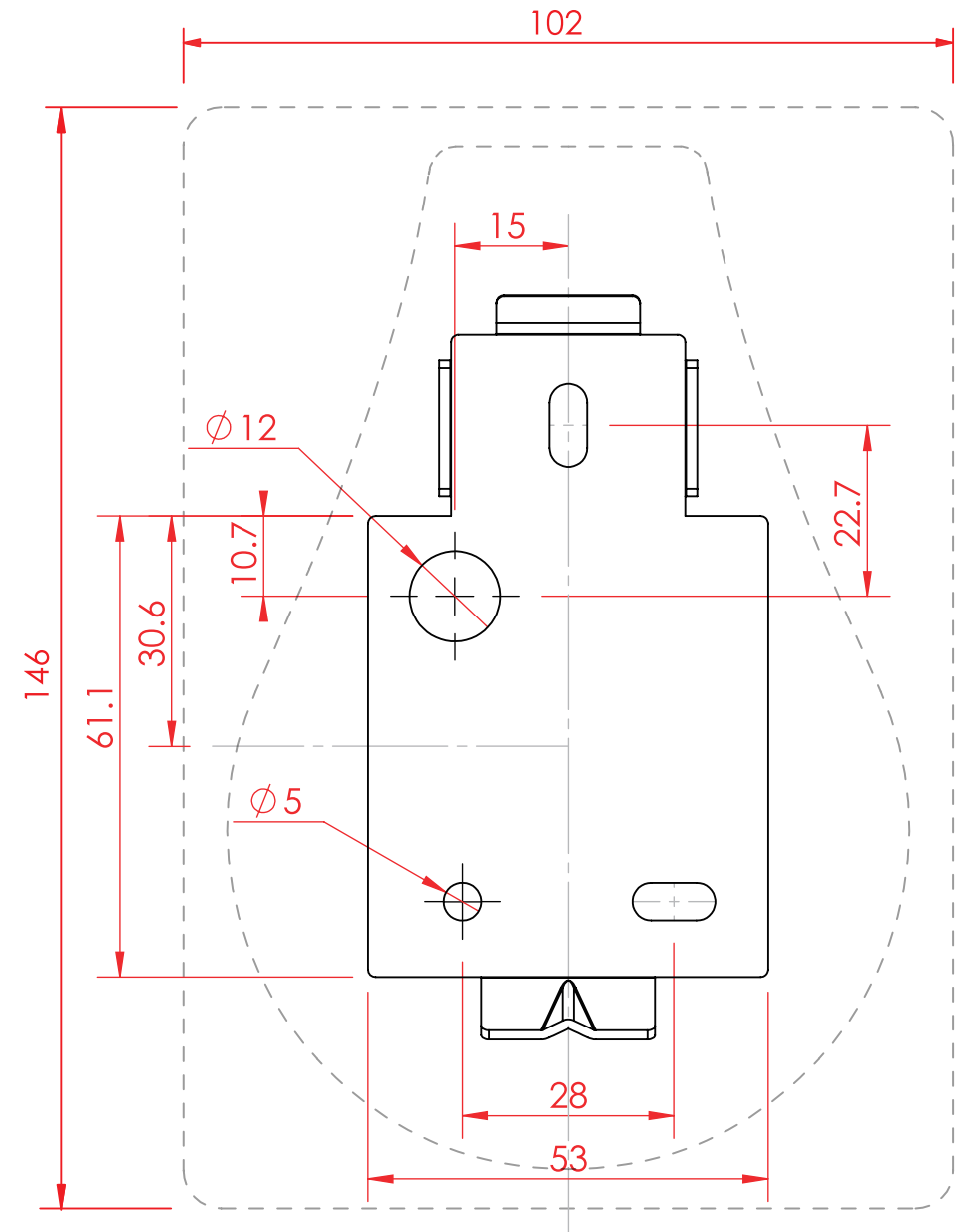
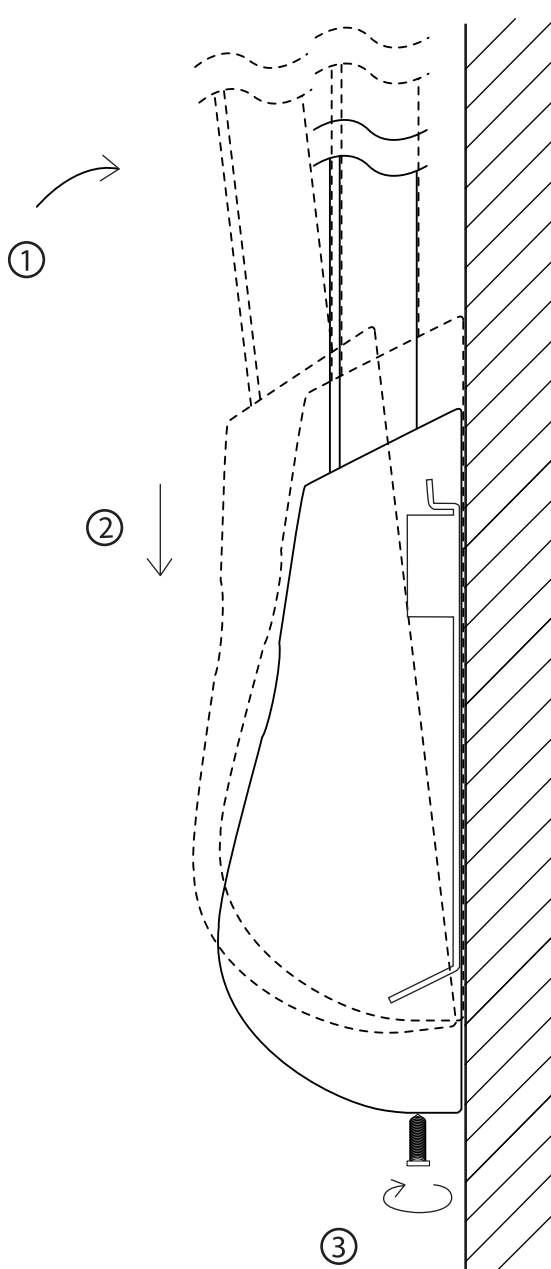

Cobra

by Innermost

220-240v . EU Installation

Class 1 

innermost

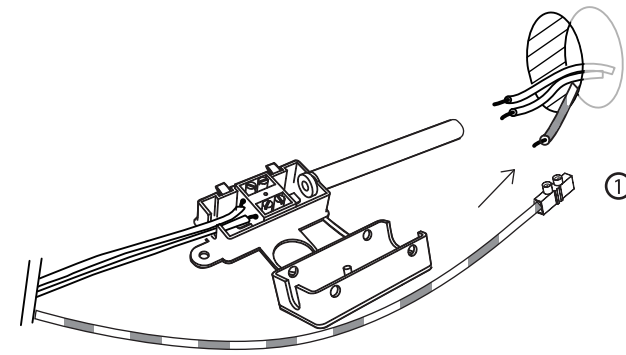
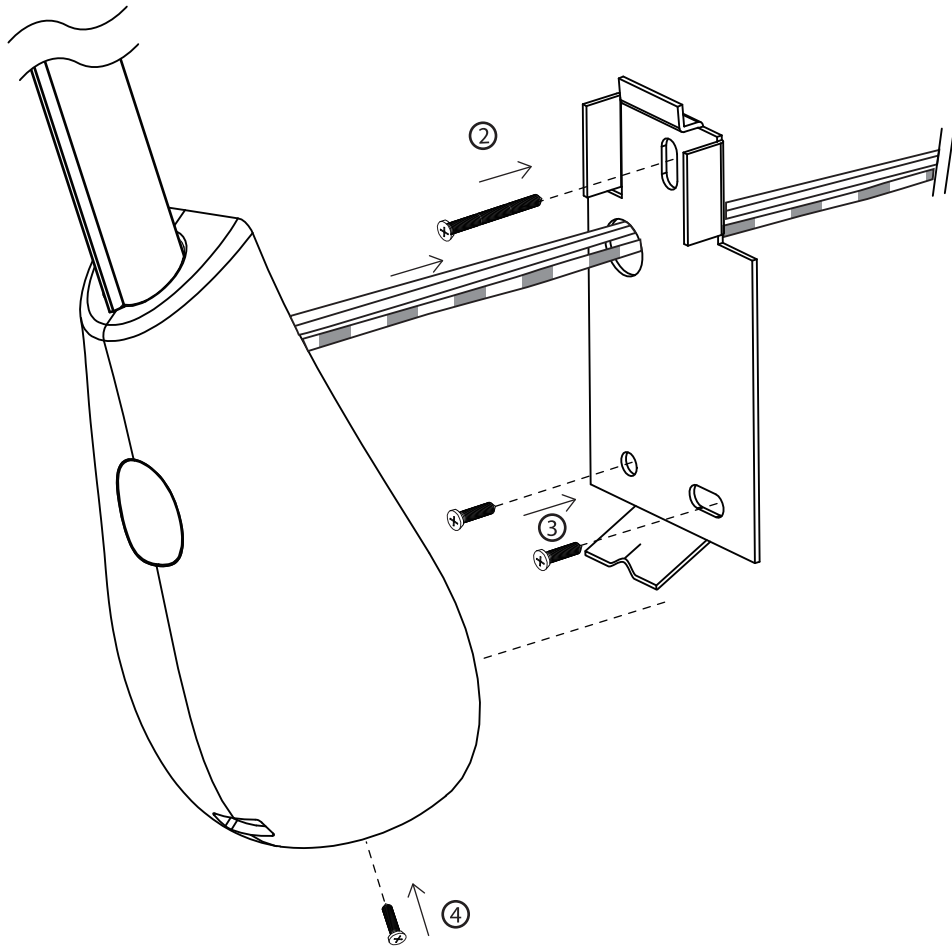

COBRA WALL 90 UK/EU - WC078190XX