

Fig.2

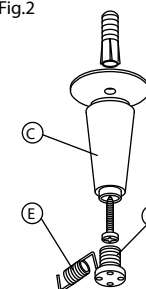

Fig.4

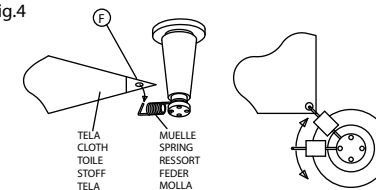

Fig.3

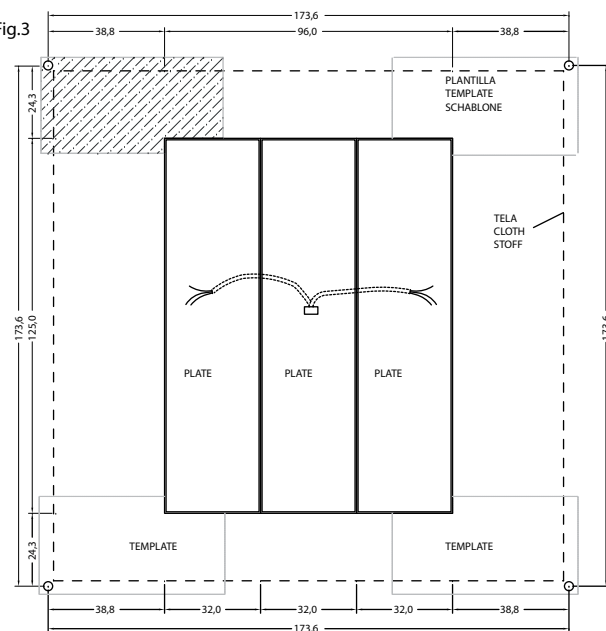
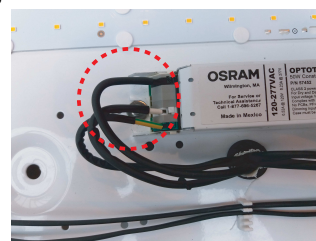

Fig.6



1. Put the plates A in the chosen place, using blocks and lag screws.
2. Connect the plates as indicated in fig 6.
3. Fix lampholders C using blocks and lag screws as per fig 2, CONSIDERING sizes as per fig 3. REMARK: Use the template in order to calculate right distances for lampholders. Be careful that an accurate plate stoppage is achieved as per fig 3. This sizes are VERY IMPORTANT to achieve a good cloth setting.
4. Screw lampholder D into C, and insert spring E into one of the holes.
5. Place the cloth by inserting holes F in the spring ends (fig 4).

TELA / FABRIC:



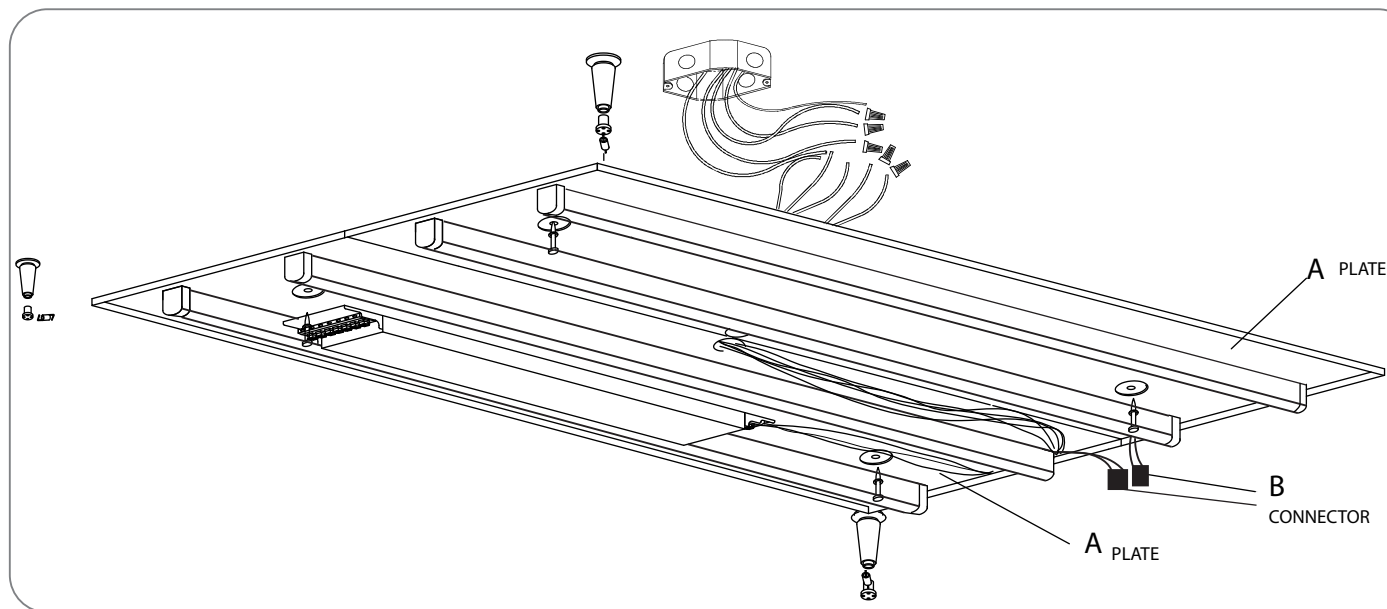

Fig.6

MALE/FEMALE  
CONNECTORS B

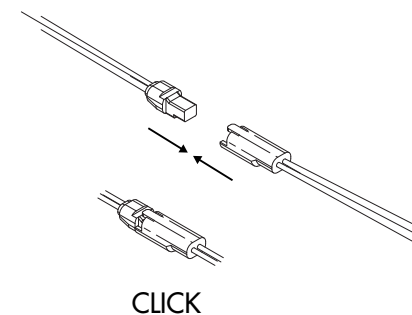
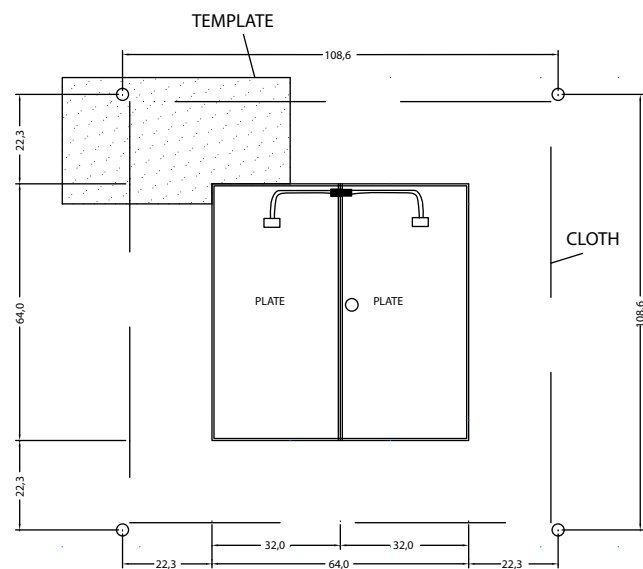

Fig.3



\* measurements in cm unless otherwise specified

Fig.2

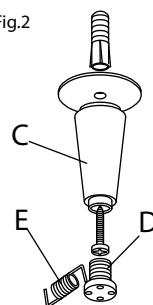
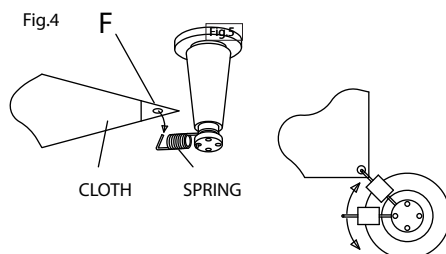

Fig.4



1. Put the plates A in the chosen place, using blocks and lag screws.
2. Connect the plates A with Male/Female connectors (B) as indicated in fig 6.
3. Fix the cones C using blocks and lag screws as fig 2.  
CONSIDERING sizes as per fig 3. REMARK: Use the template provided in order to calculate right distances for the cones. Be careful that an accurate plate stoppage is achieved as per fig 3. This sizes are VERY IMPORTANT to achieve a good cloth setting.
4. Screw the piece D into C, and insert spring E into one of the holes.
5. Place the cloth by inserting holes F in the spring ends (fig 4).

TELA / FABRIC:



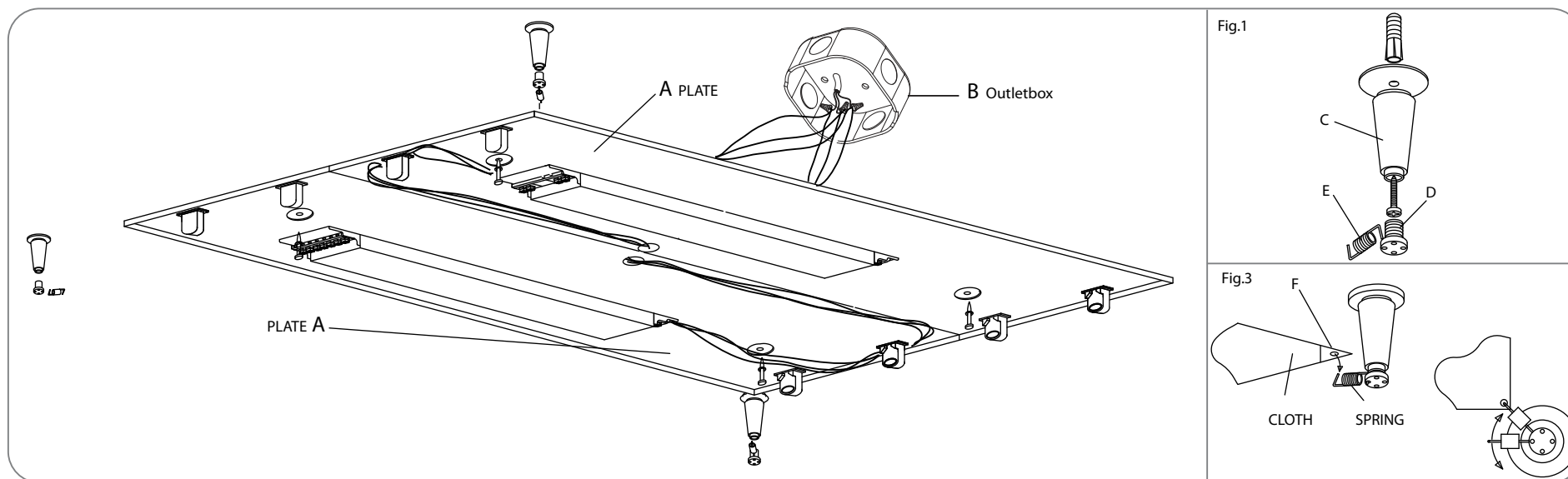
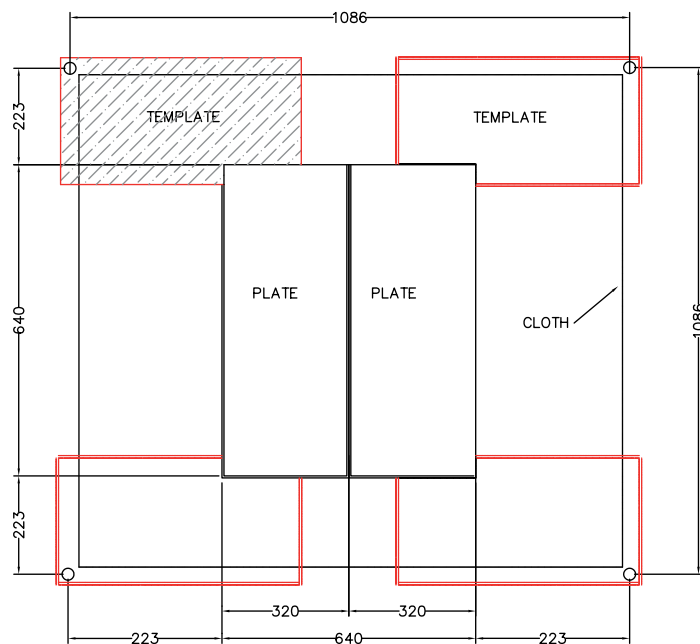

Fig.2



Measurements in mm

1. Make the electrical connection of the two plates (A).
2. Tie the plates (A) to the ceiling , using blocks and lag screws.  
It is important to place the plates coinciding the passage holes of the connection cable with the outletbox (B).
3. Fix cones (C) using blocks and lag screws (Fig.1). Take into consideration the distances shown in Fig.2.  
REMARK: Use the template in order to calculate right distances for cones (C). This sizes are VERY IMPORTANT to achieve a good cloth setting.
4. Screw piece (D) into he cone (C), and insert the spring (E) into one of the holes (Fig1).  
Place the cloth by inserting holes F in the spring ends (Fig.3).

TELA / FABRIC:



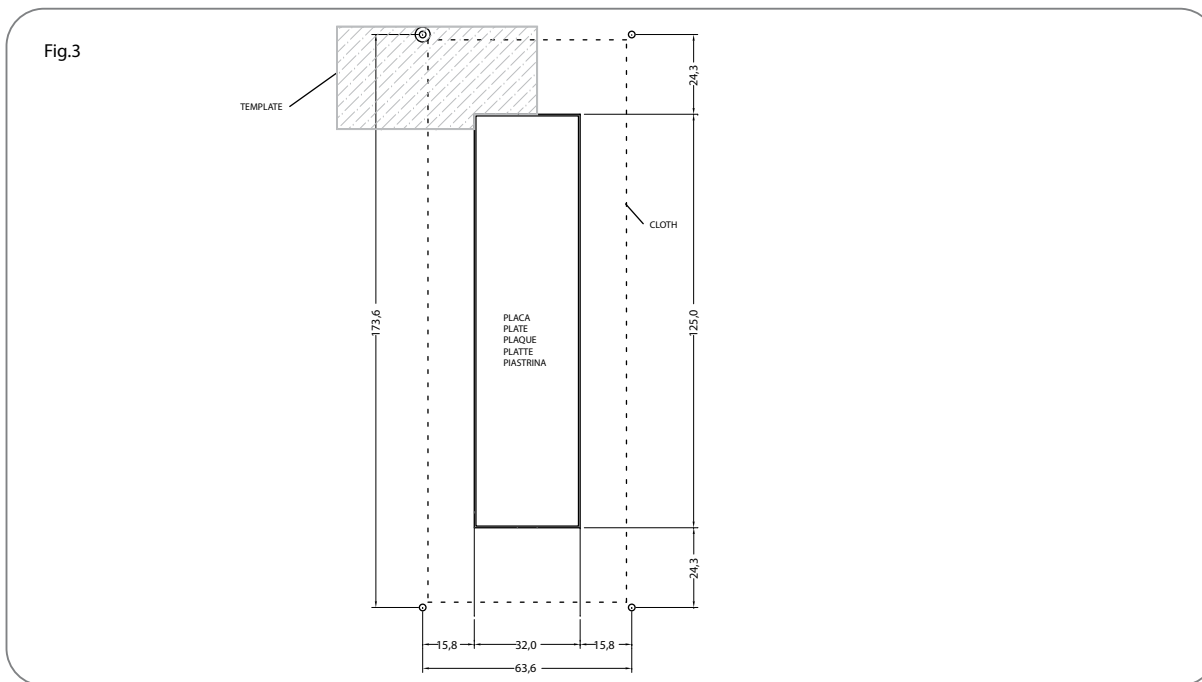
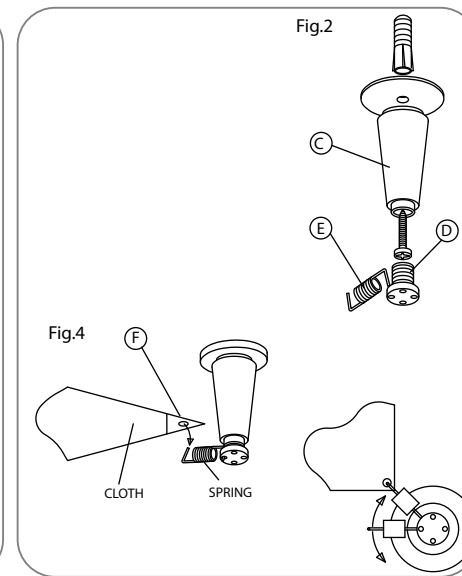
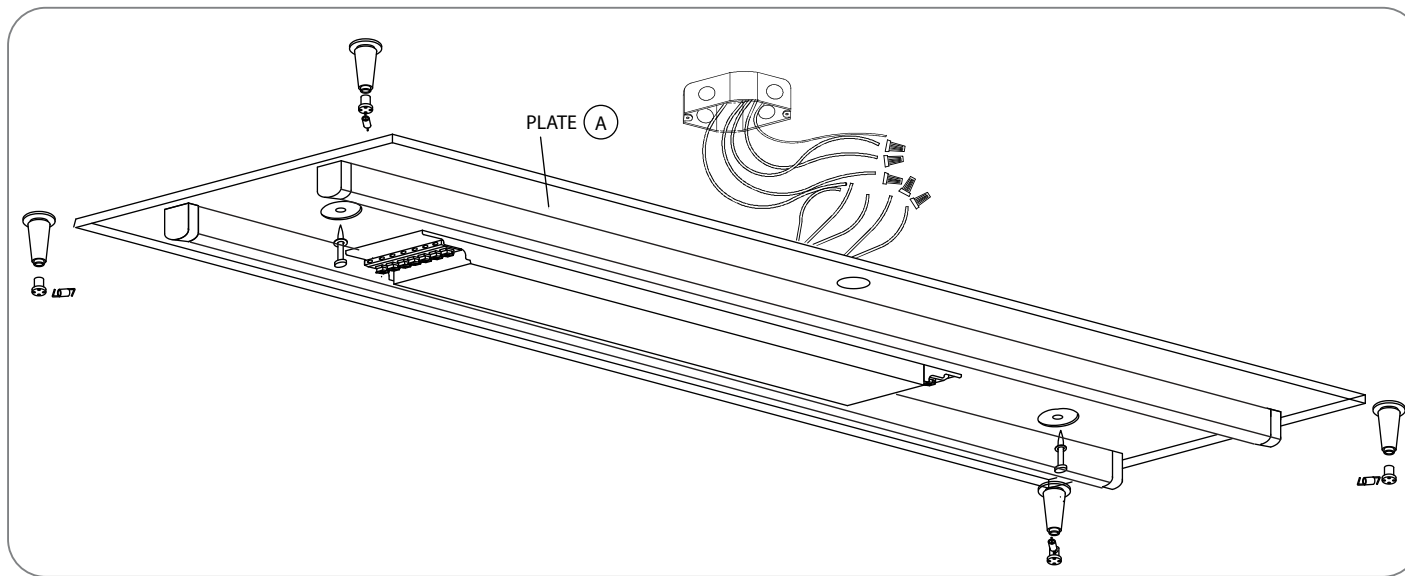

1. Put plate A in the chosen place, using blocks and lag screws.
2. Make the electrical connections.
3. Fix lampholders C using blocks and lag screws as per fig 2, CONSIDERING sizes as per fig 3. REMARK: Use the template in order to calculate right distances for lampholders. Be careful that an accurate plate stoppage is achieved as per fig 3. This sizes are VERY IMPORTANT to achieve a good cloth setting.
4. Screw lamholder D into C, and insert spring E into one of the holes.
5. Place the cloth by inserting holes F in the spring ends (fig 4).

TELA / FABRIC:



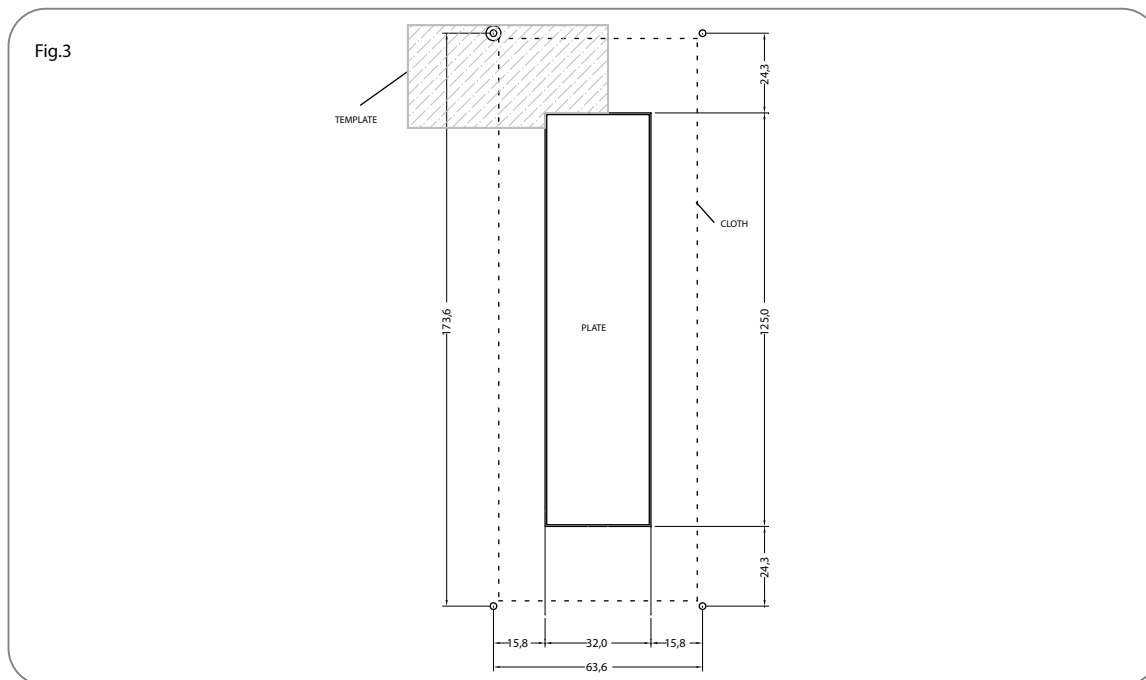
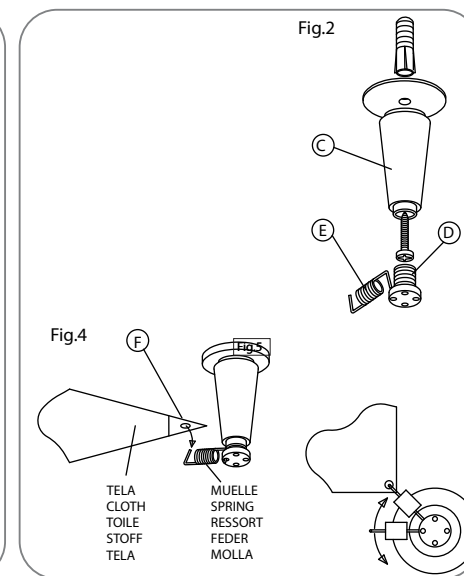
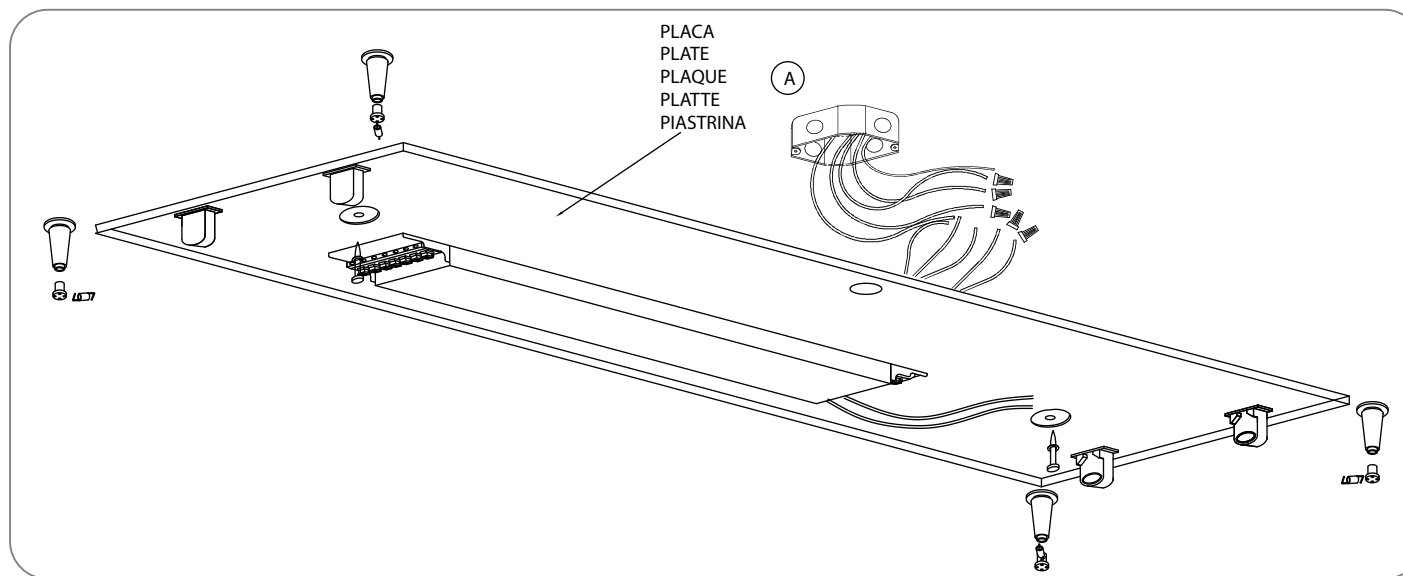

1. Put plate A in the chosen place, using blocks and lag screws.
2. Make the electrical connections.
3. Fix lampholders C using blocks and lag screws as per fig 2, CONSIDERING sizes as per fig 3. REMARK: Use the template in order to calculate right distances for lampholders. Be careful that an accurate plate stoppage is achieved as per fig 3. This sizes are VERY IMPORTANT to achieve a good cloth setting.
4. Screw lamholder D into C, and insert spring E into one of the holes.
5. Place the cloth by inserting holes F in the spring ends (fig 4).

TELA / FABRIC:



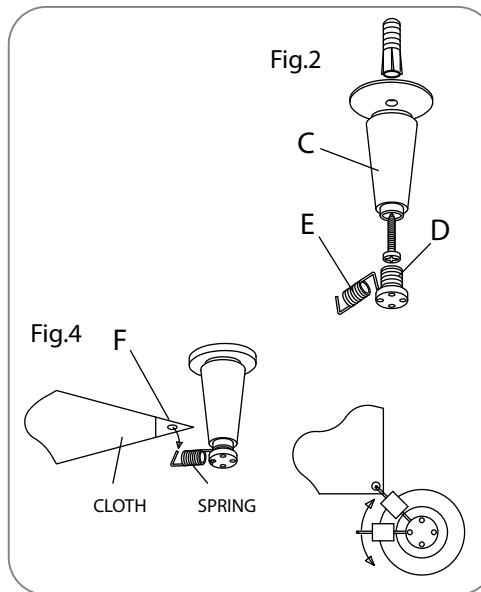
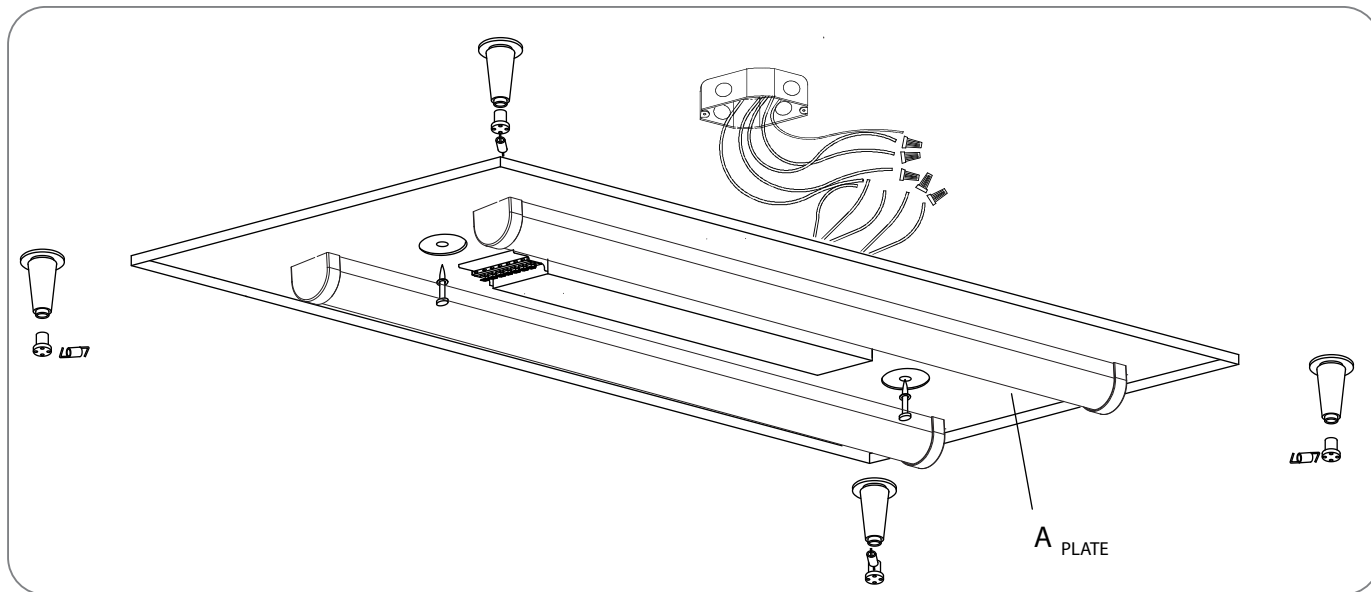
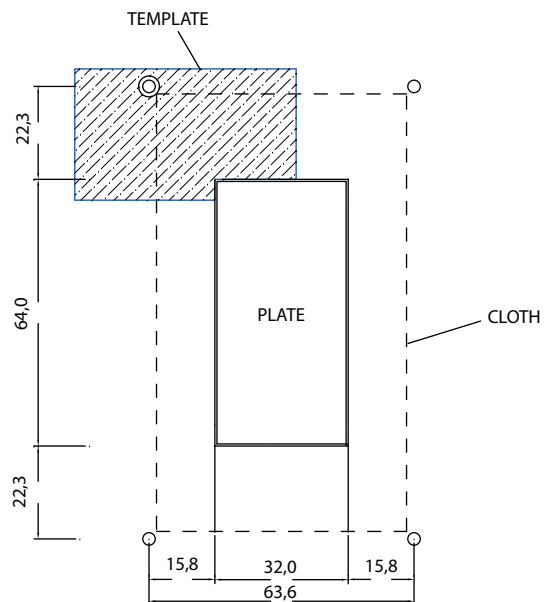

Fig.3







\* measurements in cm unless otherwise specified

1. Put plate A in the chosen place, using blocks and lag screws.
2. Make the electrical connections.
3. Fix lampholders C using blocks and lag screws as per fig 2, CONSIDERING sizes as per fig 3. REMARK: Use the template in order to calculate right distances for lampholders. Be careful that an accurate plate stoppage is achieved as per fig 3. This sizes are VERY IMPORTANT to achieve a good cloth setting.
4. Screw lamholder D into C, and insert spring E into one of the holes.
5. Place the cloth by inserting holes F in the spring ends (fig 4).

TELA / FABRIC:



#### Consumer information:

- Lamps without the IP mark are classed as IP20 and are designed for general interior use, except wet areas (bathrooms, etc.)
- Lamps with the IP mark are designed for exterior use and in wet areas. (E.g. IP54)
- They offer guaranteed protection to people and animals against electrical discharge:
  - Class I: through single electrical insulation and an earthing conductor once correctly connected.
  -  • Class II: through double electrical insulation.
  -  • Class III: these kinds of lamps should be connected at very low voltage levels (generally 12V); therefore there is no risk.
-  • Lamps with this symbol, or without any symbols, can be mounted directly onto normally inflammable surfaces.
-  • Lamps with this symbol cannot be mounted directly onto normally inflammable surfaces.
- The safety of this lamp is guaranteed by using a maximum wattage bulb that does not exceed the figure displayed visibly on the lamp.
-  • The product cannot be treated like conventional domestic waste; it must be taken to the corresponding recycling point for electrical and electronic equipment.

#### Assembly instructions

**B.lux**

B.LUX S.A.  
Pol. Ind. Okamika, pab. 1  
48289 Gizaburuaga (Bizkaia) Spain  
T. (+34) 94 682 72 72  
F. (+34) 94 682 49 02  
info@grupoblux.com  
www.grupoblux.com