

W130 (2L) LED: LED 2 x 21W 6680lm 450mA 3000K CRI80 120V 50-60Hz W130 (1L) LED: LED 21W 3340lm 450mA 3000K CRI80 120V 50-60Hz
W160 (2L) LED: LED 2 x 26,2W 8360lm 450mA 3000K CRI80 120V 50-60Hz W160 (1L) LED: LED 26,2W 4180lm 450mA 3000K CRI80 120V 50-60Hz
W250 (2L) LED: LED 2 x 44,6W 14200lm 450mA 3000K CRI80 120V 50-60Hz W250 (1L) LED: LED 44,6W 7100lm 450mA 3000K CRI80 120V 50-60Hz

IP20 Clase I

1

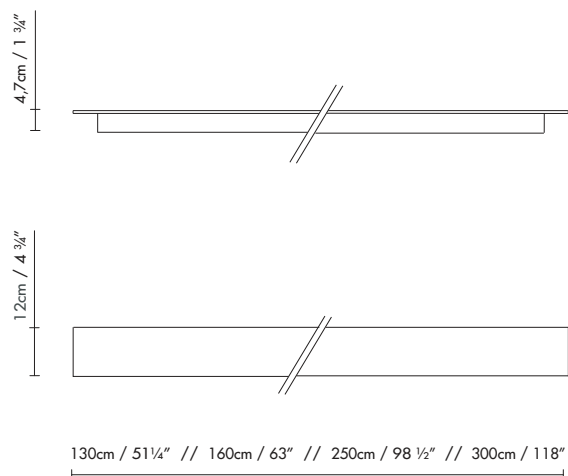

2

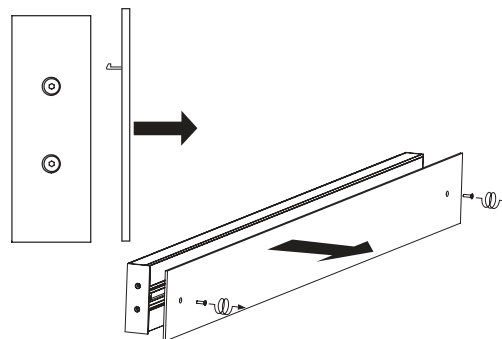

1. General dimensions of the lamp.
2. Remove the side cover by unscrewing the front screws.
3. Fix the lighting fixture to the wall with the supplied screws and plugs.
4. Remove the protection from the adhesive in the plate, position and fix the plate to the lighting fixture by pressing to ensure the proper bonding of the plate against the structure.

3

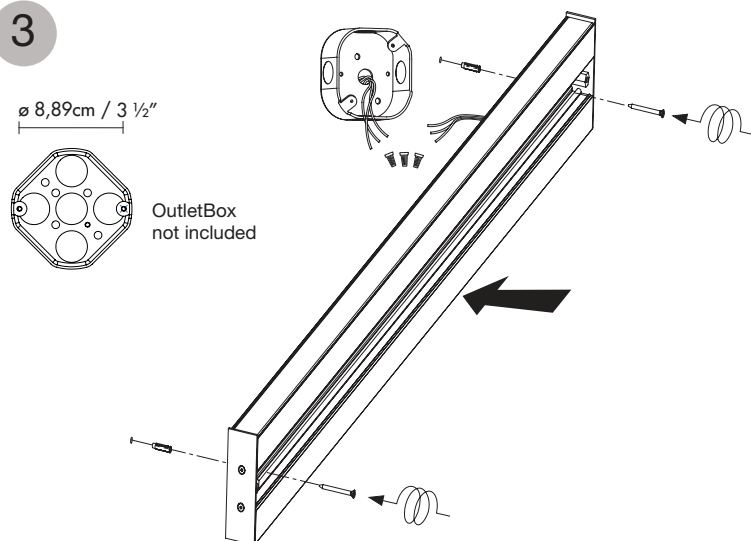



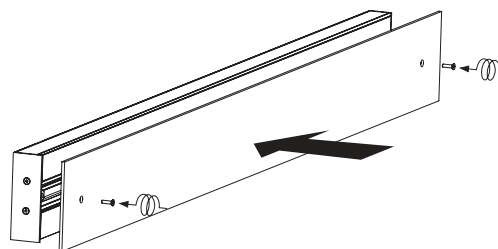

4

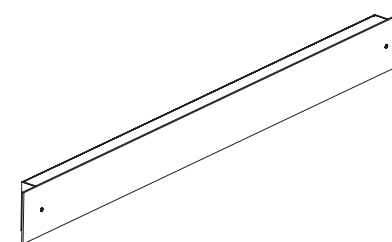

5



Consumer information:

- Lamps without the IP mark are classed as IP20 and are designed for general interior use, except wet areas (bathrooms, etc.)
- Lamps with the IP mark are designed for exterior use and in wet areas. (E.g. IP54)
- They offer guaranteed protection to people and animals against electrical discharge:
 - Class I: through single electrical insulation and an earthing conductor once correctly connected.
 -  • Class II: through double electrical insulation.
 -  • Class III: these kinds of lamps should be connected at very low voltage levels (generally 12V); therefore there is no risk.
-  • Lamps with this symbol, or without any symbols, can be mounted directly onto normally inflammable surfaces.
-  • Lamps with this symbol cannot be mounted directly onto normally inflammable surfaces.
- The safety of this lamp is guaranteed by using a maximum wattage bulb that does not exceed the figure displayed visibly on the lamp.
-  • The product cannot be treated like conventional domestic waste; it must be taken to the corresponding recycling point for electrical and electronic equipment.

Assembly instructions

B.lux

B.LUX S.A.
Pol. Ind. Okamika, pab. 1
48289 Gizaburuaga (Bizkaia) Spain
T. (+34) 94 682 72 72
F. (+34) 94 682 49 02
info@grupoblux.com
www.grupoblux.com