

MOZZI

Pendant

/Large
/Small

Flush mount

/Large
/Small

Portable lamp

"If you want simple lights with glass globe but bit tired of geometric sphere, or need a little more accents, MOZZI would be an option."

design by
BYMARS

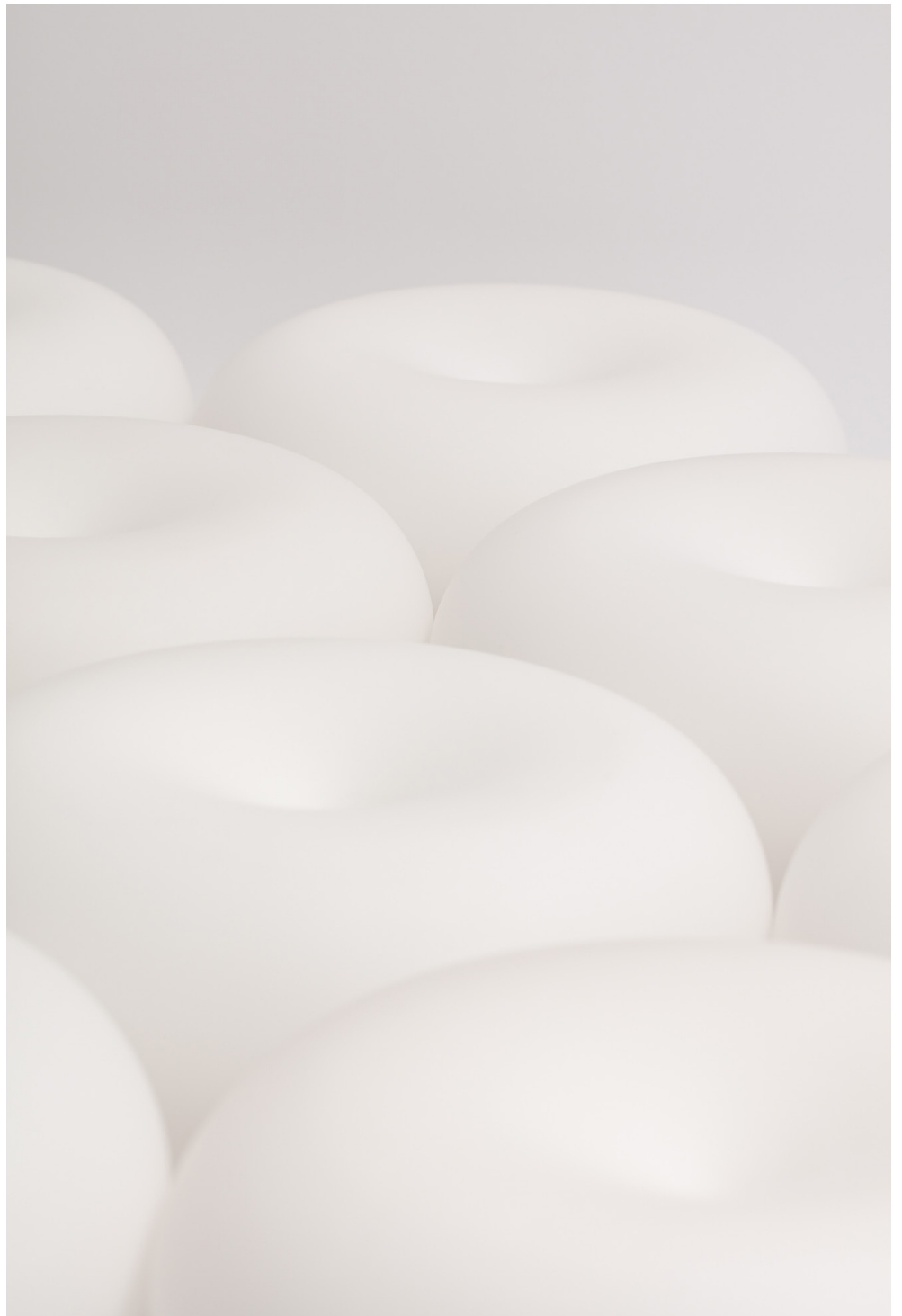

A G O

A gentle dimple in the middle of the MOZZI can remind lightly poked Mochi, a soft and chewy Japanese rice-cake. The most of residential space which needs ambient light to soften the mood can be a new home for MOZZI. MOZZI comes with two sizes in two different orientations; wall/ ceiling lamp and pendant lamp.

Collection
MOZZI

Model
Pendant Large

Type
Suspended

Designer
BYMARS

A



Size(mm)

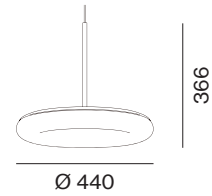

Weight : 4.7 kg

Material : Coated Aluminium,
Matt Opal glass

Light Source : Integrated LED (SMD), DC

Wattage : 13 W

Lumen : 1160 lm

Lumen/W : 88

CRI : >80

Dimmable : Yes

Power control : Triac dimming compatible

Voltage : 120 V

Color temperature : 2700 / 3000 K

Ingress protection rating : IP 20

Class : Class I

Cable lengths : 3m

Ceiling cup/Bracket : INCL.

Ceiling cup dim.(mm) : Ø 108, H 54

Regional certification : UL

Color : Charcoal

Item no.
MZPD0204-L01

G



Color : Egg white

Item no.
MZPD0204-L02



Color : Terracotta

Item no.
MZPD0204-L08



Color : Gray

Item no.
MZPD0204-L03



AGO lighting

04545 서울특별시
중구 을지로 157 554호

No.554, Euljiro 157, 04545
Jung-gu, Seoul, Korea

+82 02 2268 0568
www.agolighting.com

A

Installation instruction

Ceiling cup dim.(mm) : Ø 108, H 54

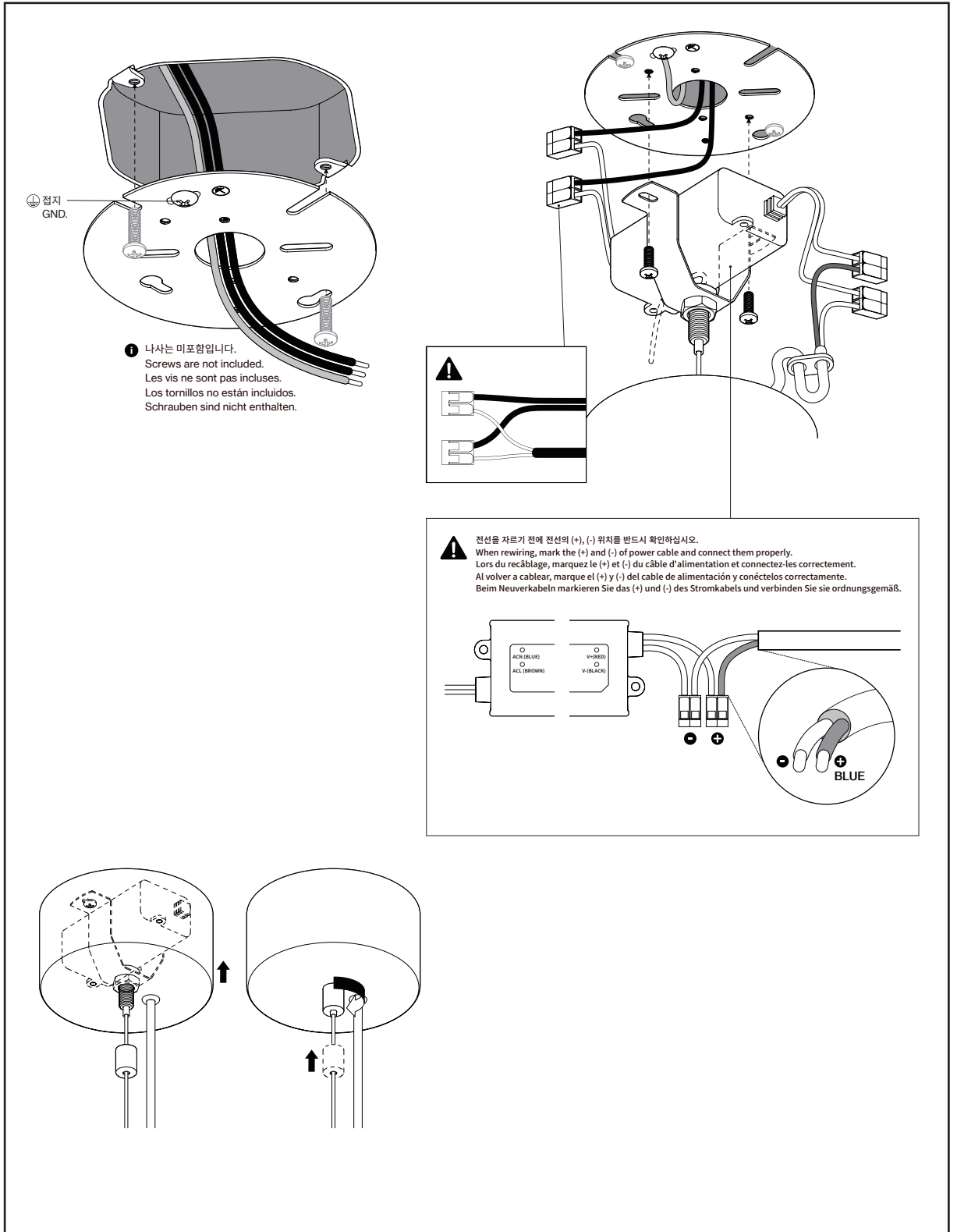

G



Collection
MOZZI

Model
Flush mount Large

Type
Surface mounted

Designer
BYMARS

A

Size(mm)

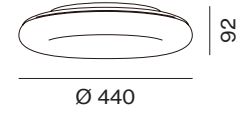

Weight : 4.7 kg

Material : Coated Aluminium,
Matt Opal glass

Light Source : Integrated LED (SMD), DC

Wattage : 13 W

Lumen : 1160 lm

Lumen/W : 88

CRI : >80

Dimmable : Yes

Power control : Triac dimming compatible

Voltage : 120 V

Color temperature : 2700 / 3000 K

Ingress protection rating : IP 20

Class : Class I

Ceiling cup/Bracket : Included

Ceiling cup dim.(mm) : Ø 252, H 32

Regional certification : UL

Color : Terracotta

Item no.
MZCL0204-L08

G



Color : Egg white

Item no.
MZCL0204-L02



Color : Gray

Item no.
MZCL0204-L03



Color : Charcoal

Item no.
MZPD0204-L01

O

AGO lighting

04545 서울특별시
중구 을지로 157 554호

No.554, Euljiro 157, 04545
Jung-gu, Seoul, Korea

+82 02 2268 0568
www.agolighting.com

A

Polar Luminous Intensity Distribution

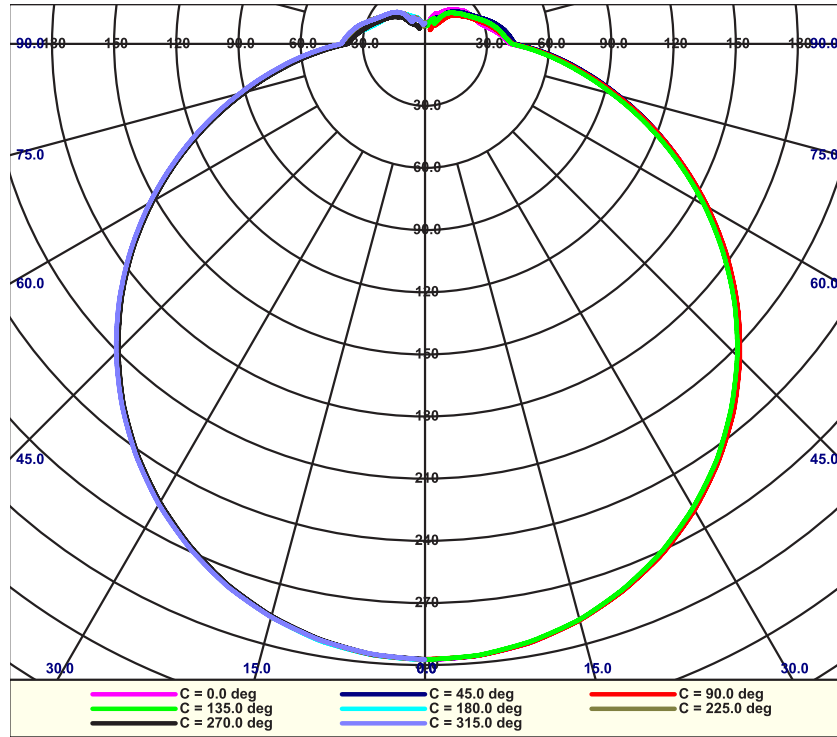

G

Cartesian Luminous Intensity Distribution

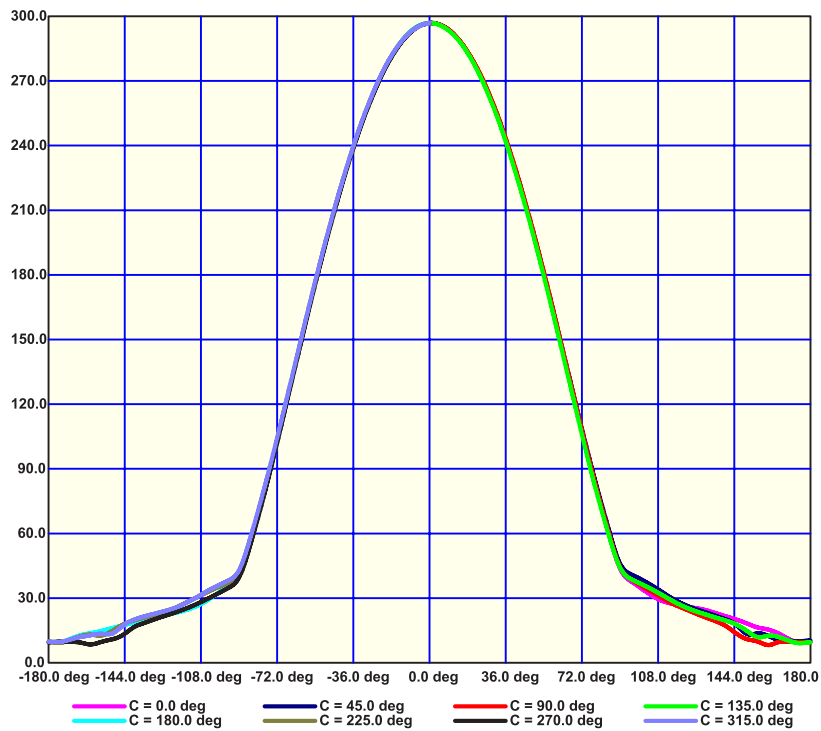

Collection
MOZZI

Model
Pendant Small

Type
Suspended

Designer
BYMARS

A



Size(mm)

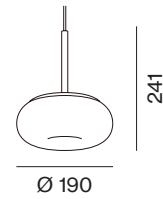

Weight : 1.1 kg

Material : Coated Aluminium,
Matt Opal glass

Light Source : Integrated LED (SMD), AC

Wattage : 6 W

CRI : >90

Dimmable : Yes

Power control : Triac dimming compatible

Voltage : 120 V

Color temperature : 2700 / 3000 K

Ingress protection rating : IP 20

Class : Class I

Cable lengths : 3m

Ceiling cup/Bracket : INCL.

Ceiling cup dim.(mm) : Ø 90, H 40

Regional certification : UL

Color : Gray

Item no.
MZPD0203-S03

G



Color : Terracotta

Item no.
MZPD0203-08



Color : Charcoal

Item no.
MZPD0203-S01



Color : Egg white

Item no.
MZPD0203-S02



AGO lighting

04545 서울특별시
중구 을지로 157 554호

No.554, Euljiro 157, 04545
Jung-gu, Seoul, Korea

+82 02 2268 0568
www.agolighting.com

A

Installation instruction

Ceiling cup dim.(mm) : Ø 90, H 40

G

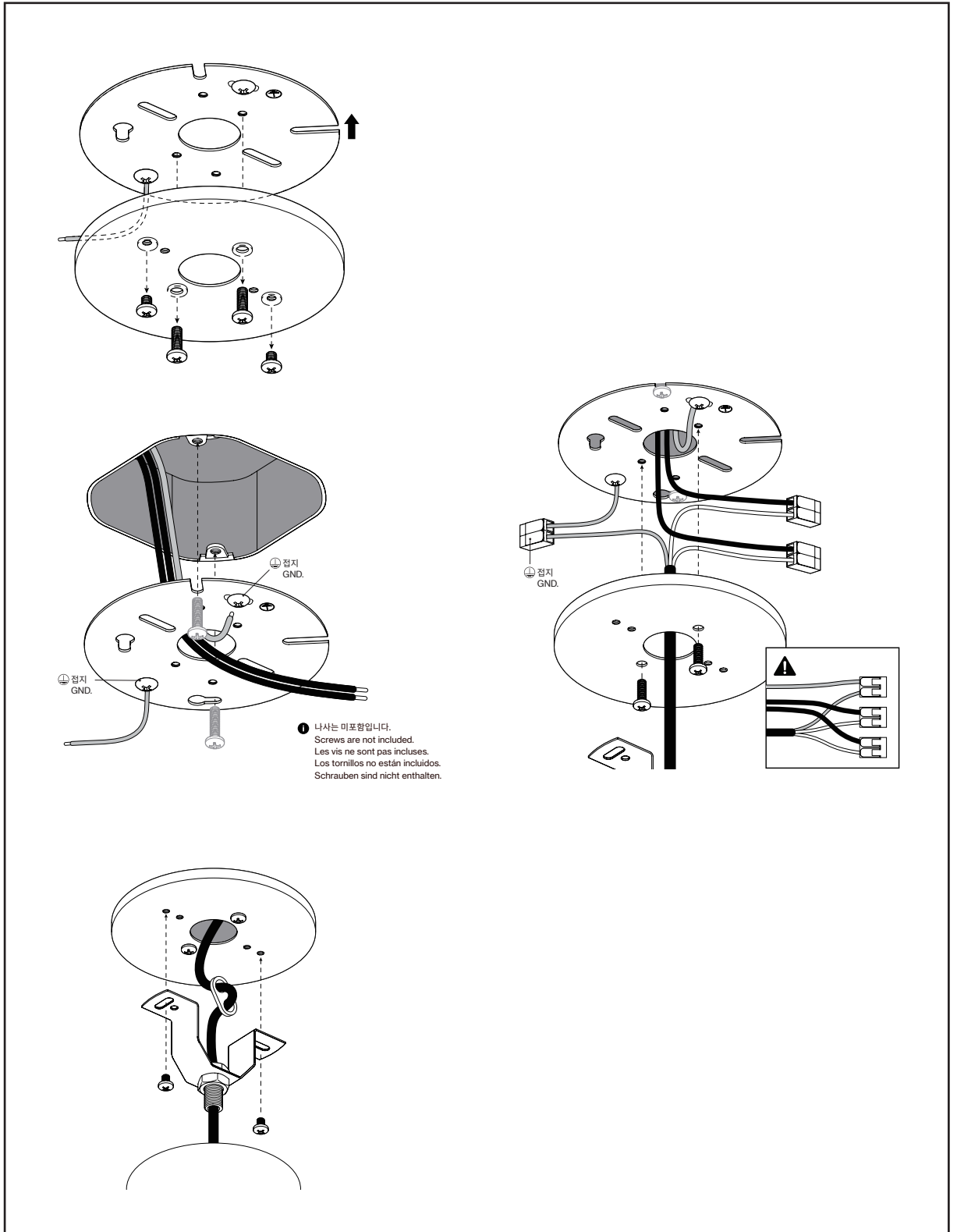

Collection
MOZZI

Model
Flush mount Small

Type
Surface mounted

Designer
BYMARS

A

Size(mm)

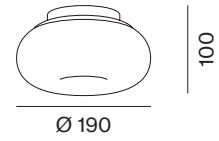

Weight : 0.9 kg

Material : Coated Aluminium
Matt Opal glass

Light Source : Integrated LED (SMD), AC

Wattage : 6 W

CRI : >90

Dimmable : Yes

Power control : Triac dimming compatible

Voltage : 120 V

Color temperature : 2700 / 3000 K

Ingress protection rating : IP 20

Class : Class I

Ceiling cup/Bracket : Included

Ceiling cup dim.(mm) : Ø 105, H 13.5

Regional certification : UL

Color : Egg white

Item no.
MZCL0203-S02

G



Color : Charcoal

Item no.
MZCL0203-S01



Color : Gray

Item no.
MZCL0203-S03



Color : Terracotta

Item no.
MZPD0203-S09



AGO lighting

04545 서울특별시
중구 을지로 157 554호

No.554, Euljiro 157, 04545
Jung-gu, Seoul, Korea

+82 02 2268 0568
www.agolighting.com

A

Installation instruction

Ceiling cup dim.(mm) : Ø 105, H 13.5

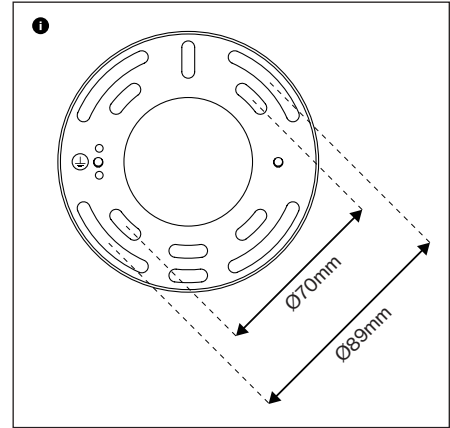
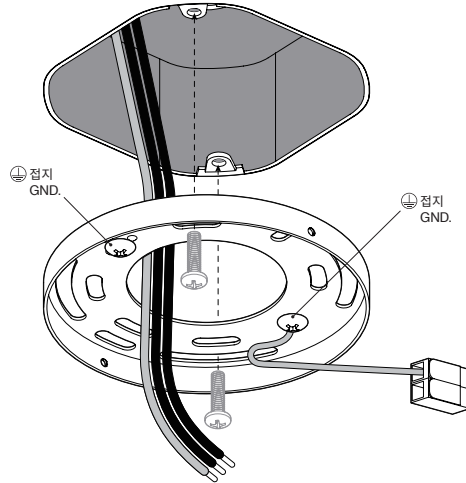

- ① 나사는 미포함입니다.
Screws are not included.
Les vis ne sont pas incluses.
Los tornillos no están incluidos.
Schrauben sind nicht enthalten.

G

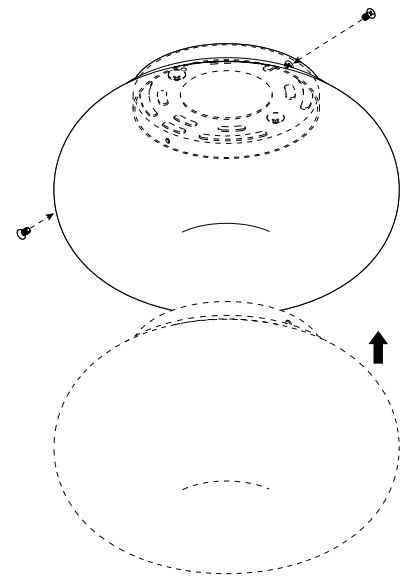
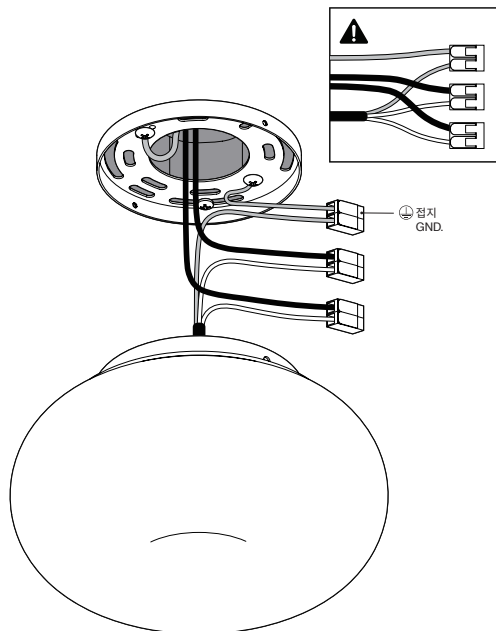

Collection
MOZZI

Model
ABLE (Portable lamp)

Type
Free standing

Designer
BYMARS

A



Color : Terracotta

Item no.
MZTB0203-S08

Size(mm)

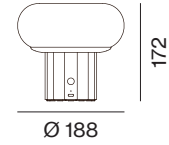

Weight : 1.1 kg

Material : Coated Aluminium
Matt Opal glass

Light Source : Integrated LED (SMD), DC

Wattage : 3 W

CRI : >90

Dimmable : Yes

Power control : 6 Steps touch dimming (0.5 ~ 3 W)

Voltage : 120 V

Color temperature : 3000 K

Ingress protection rating : IP 44

Class : Class III

Cable lengths : 1.5 m

Power : Rechargeable Li-ion battery
3350 mA, 3.7 V

Charging time : About 7 hours

Operating time : 4.5 hours at the highest level
more than 30 hours at the lowest level

Power adaptor : 5 V 2 A / 3 A (not INCL.)

Regional certification : UL

G



Color : Egg white

Item no.
MZTB0203-S02



Color : Gray

Item no.
MZTB0203-S03



Color : Green

Item no.
MZTB0203-S04



Color : Mustard

Item no.
MZTB0203-S14

O

AGO lighting

04545 서울특별시
중구 을지로 157 554호

No.554, Euljiro 157, 04545
Jung-gu, Seoul, Korea

+82 02 2268 0568
www.agolighting.com



A

G

O

