



Virga, brushed aluminum



Virga, black anodized aluminum

Virga linear pendant

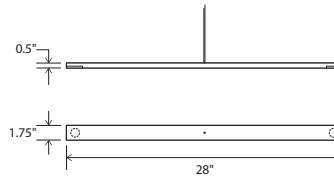

Dimensions: 28" x 1.75" x 0.5"
 Materials: aluminum, polymer
 Product weight: 6 lb
 Light source: integrated LED
 Light output: 1126 Lumens (source)
 Light color: 2700 K or 3500 K
 Color accuracy: 90+ CRI
 Power usage: 13 W
 Dimmable (see driver below)
 Extended-profile square canopy included,
 required to house LED driver (3.25" x 2.25" x 1.25")
 Canopy dimensions: 4.5" x 4.5", 1.63"
 Canopy finish matches fixture's metal finish
 See website for more canopy information
 48" suspension tube (can be shortened in field)
 Swivel option available for sloped ceilings,
 see drawing below
 Specifications subject to change



MATERIAL & FINISH OPTIONS

Virga part # 06-130-

Metal Finish
 brushed aluminum (CM-006) A
 black anodized aluminum (CM-007) B

Lamping
 2700 K LED 27
 3500 K LED 35

Driver
 120-277 V AC input voltage
 0-10V dimming
 TRIAC and ELV dimming at
 120 V AC only

Includes
 polymer shade (CM-052)

Available for sloped ceilings:
 Sloped Extended-Profile Square Canopy

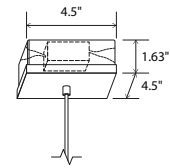

extended-profile
square canopy
brushed aluminum



brushed aluminum
(CM-006)



black anodized aluminum
(CM-007)

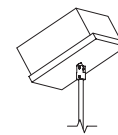

A clean, minimal fixture executed without compromise. The very simple and sleek down light bar can be installed in very close proximity to its user – and withstand close scrutiny.

Nick Sheridan
Designer

