

CONTENTS

Rudi Loop 03

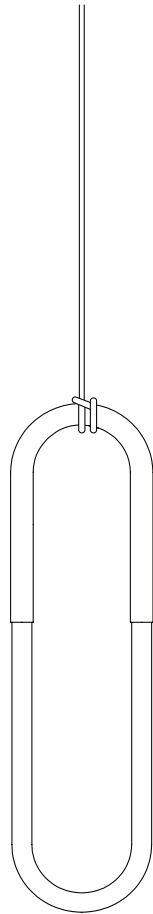

Canopy

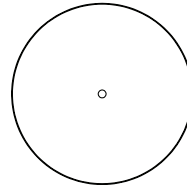

Crossbar Driver Package

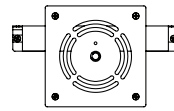

8-32 Crossbar Screws (2)



SAFETY INFORMATION

Only suitable for direct mounting on non-combustible surfaces.

Under no circumstances can Rudi Pendants be mounted on normally flammable surfaces.

Suitable for dry, indoor use only.

Maximum ambient temperatures: 25° C

RUDI INSTALLATION

Note: Please contact a licensed electrician.

1. Install the crossbar (B) using #8-32 screws through arced slots to junction box (A). Feed wires from junction box through the center hole of the crossbar.
2. Run cord (F) up through the crossbar bottom plate (G) and tie a knot in the cord to create desired hanging length. Crimp the metal strain relief around the cord just above the bottom plate.
3. Make wire connections between the transformer and the fixture, and then while holding the fixture up, make wire connections between the junction box and the transformer.
4. Take off the four standoff screws (E) and re-fasten the bottom plate to the top plate. Once the crossbar is secure, raise the canopy (C) and secure with thumb nut (D) until canopy is flush with ceiling.

