

CONTENTS

Counterweight Sconce

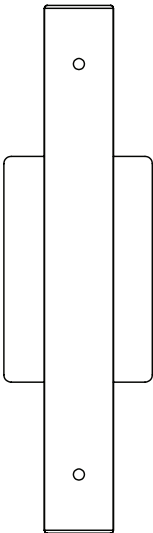

Glass Shade

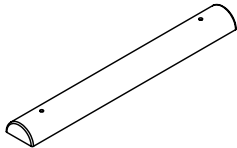

Custom Crossbar

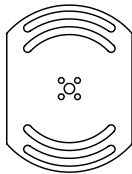

8-32 Thumb screws (2)



8-32 long screws (2)



8-32 Crossbar Screws (2)



SAFETY INFORMATION

Only suitable for direct mounting on non-combustible surfaces.
Under no circumstances can Counterweight Fixtures be mounted on normally flammable surfaces.
Suitable for dry, indoor use only.
Maximum ambient temperatures: 25° C

SCONCE INSTALLATION

Note: Please contact a licensed electrician.

Note: Do not use bulbs that exceed 60 watts.

1. Pull the leads from the fixture through the custom crossbar.
2. Join the leads from the fixture to the leads from the wall in the junction box with wire nuts. Stuff the excess cord into the junction box.
3. Attach the custom crossbar to the junction box with the provided 8-32 screws.
4. Align the fixture with the holes of crossbar. Thread the two long 8-32 screws through the center of the fixture into the two threaded holes of the custom crossbar.
5. Make adjustments to the crossbar when necessary to make the fixture level.

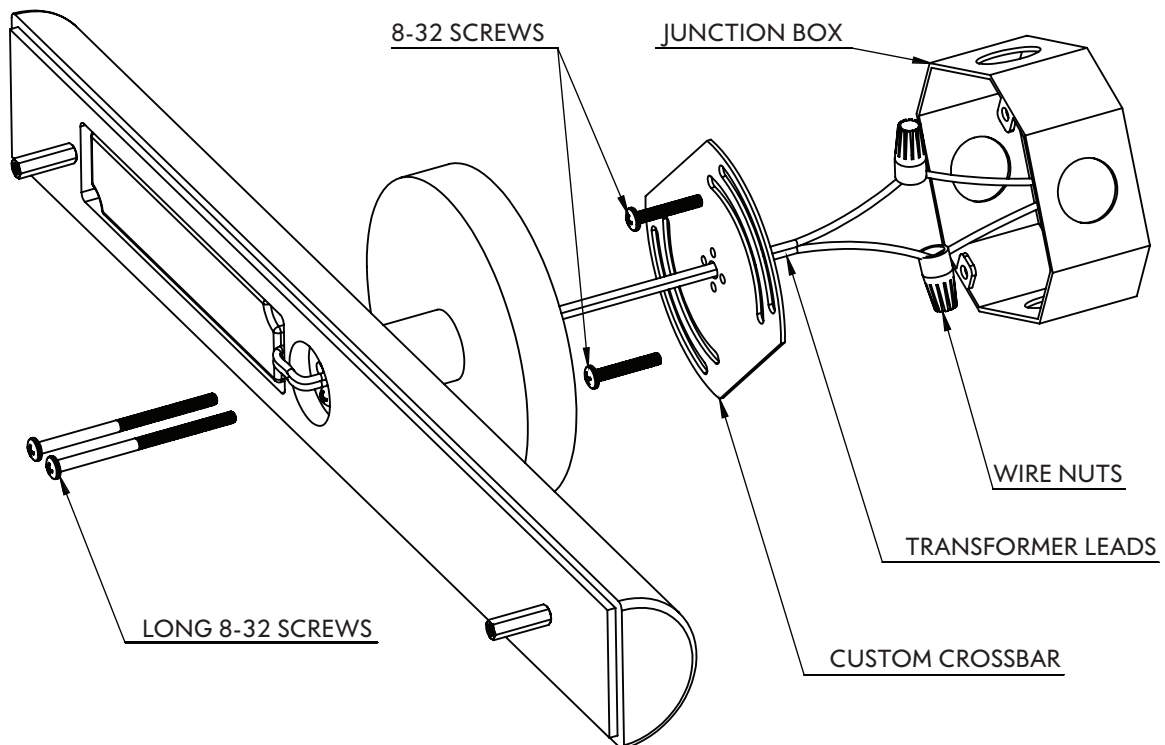

GLASS ASSEMBLY

1. Position the holes of the glass over the holes of the standoffs on the fixture.
2. Screw in the 8-32 thumb screws until the glass is firmly pressed against the wood. Do not over tighten, or the glass will have a chance of breaking.

